

SCANCARELLA, DEVISEES OF ELAINE R.
428 WEST RD
BOWDOIN ME 04287

			Property Data			Assessment Record						
			Neighborhood	9 Map 9		Year	Land	Buildings	Exempt	Total		
			Tree Growth Year	0		2009	0	57,930	10,000	47,930		
			Farmland Yr	0		2010	0	57,930	10,000	47,930		
			Open Space Yr	0		2011	0	57,930	10,000	47,930		
			Zone/Land Use	11 Residential 1		2012	0	57,930	10,000	47,930		
			Secondary Zone			2013	0	55,980	10,000	45,980		
			Topography			2014	0	55,980	10,000	45,980		
			1.Level	4.Below St	7.LevelBog	2015	0	55,980	15,000	40,980		
			2.Rolling	5.Low	8.Conform	2016	0	55,980	20,000	35,980		
			3.Above St	6.FZone	9.Non-Confor	2017	0	55,980	0	55,980		
			Utilities			2018	0	55,980	0	55,980		
			1.Public	4.Dr Well	7.Cesspool	2019	0	55,980	0	55,980		
			2.Water	5.Dug Well	8.	2020	0	58,350	0	58,350		
			3.Sewer	6.Septic	9.None	2021	0	58,350	0	58,350		
			Street			2022	0	47,340	0	47,340		
			1.Paved	4.Proposed	7.MHG	Land Data						
			2.Semi Imp	5.R/O/W	8.DIS							
			3.Gravel	6.MHP	9.None	Front Foot		Effective		Influence		Influence Codes
			TG PLAN YEAR		0		Type		Frontage	Depth	Factor	
			Tif District #	0		11.Road Frontage						1.Unimproved
			Sale Data					12.Delta Triangle				
Sale Date						13.Nabla Triangle						
			Price			14.Rear Land						4.Size/Shape
			Sale Type			15.Miscellaneous						
			1.Land	4.Mobile	7.C/I L&B	Square Foot		Square Feet				6.Restriction
			2.L & B	5.Other	8.	16.Regular Lot						
			3.Building	6.C/I Land	9.	17.Secondary Lot						8.View/Environ
								18.Hydro Facility				
								19.Improvements				
					20.Base 3 (Fract)							
					Fract. Acre		Acres/Sites				30.Rear Land 3	
					21.Base 1 (Fract)							
					22.Base 2 (Fract)						32.Pasture	
					23.Base 3							
					Acres						34.Softwood F&O	
					24.Base 1							
					25.Base 2						36.Hardwood F&O	
					26.Frontage 1							
					27.Rear Land 4						38.Mixed Wood TG	
					28.Rear Land 1							
					29.Rear Land 2						40.Wasteland	
											42.2nd Site	
											44.Lot Improvemen	
											46.Golf Course	

Bowdoin

Map Lot 09-27-A

Account 964

Location 428 WEST RD

Card 1 Of 1 7/19/2022

Building Style	SF Bsmt Living	Layout
0.Not Code 4.Cape 8.Log	Fin Bsmt Grade	1.Typical 4. 7.
1.Conv. 5.Garrison 9.Other	OCCUPANCY	2.Inadeq 5. 8.
2.Ranch 6.Split 10.DW	Heat Type 100%	3.Poor 6. 9.
3.R Ranch 7.Contemp 11.Church	0.Not Code 4.Steam 8.FI/Wall	Attic
Dwelling Units	1.HWBB 5.FWA 9.No Heat	1.1/4 Fin 4.Full Fin 7.
Other Units	2.HWCI 6.GravWA 11.	2.1/2 Fin 5.FI/Stair 8.
Stories	3.H Pump 7.Electric 12.	3.3/4 Fin 6. 9.None
1.1 4.1.5 7.4	Cool Type 0%	Insulation
2.2 5.1.75 8.20	1.Refrig 4.W&C Air 7.	1.Full 4.Minimal 7.
3.3 6.2.5 9.Yurt	2.Evapor 5. 8.	2.Heavy 5. 8.
Exterior Walls	3.H Pump 6. 9.None	3.Capped 6. 9.None
0.Not Code 4.Asbestos 8.Concrete	Kitchen Style	Unfinished %
1.Wood 5.Stucco 9.Other	1.Modern 4.Obsolete 7.	Grade & Factor
2.Vin/Al 6.Brick 10.Board B	2.Typical 5. 8.	1.E Grade 4.B Grade 7.
3.Compos. 7.Stone 12.	3.Old Type 6. 9.None	2.D Grade 5.A Grade 8.
Roof Surface	Bath(s) Style	3.C Grade 6.AA Grade 9.Same
1.Asphalt 4.Composit 7.	1.Modern 4.Obsolete 7.	SQFT (Footprint)
2.Slate 5.Wood 8.	2.Typical 5. 8.	Condition
3.Metal 6.Other 9.	3.Old Type 6. 9.None	1.Poor 4.Avg 7.V G
SF Masonry Trim	# Rooms	2.Fair 5.Avg+ 8.Exc
SEPTIC DESIGN	# Bedrooms	3.Avg- 6.Good 9.Same
BLDG PERMIT	# Full Baths	Phys. % Good
Year Built	# Half Baths	Funct. % Good
Year Remodeled	# Addn Fixtures	Functional Code
Foundation	# Fireplaces	1.Incomp 4.Delap 7.No Power
1.Concrete 4.Wood 7.		2.O-Built 5.Bsmt 8.LongTerm
2.C Block 5.Slab 8.		3.Damage 6.Dbwd 9.None
3.Br/Stone 6.Piers 9.		Econ. % Good
Basement		Economic Code
1.1/4 Bmt 4.Full Bmt 7.		0.None 3.No Power 7.
2.1/2 Bmt 5.None 8.		1.Location 4.Generate 8.
3.3/4 Bmt 6. 9.None		2.Encroach 9.None 9.
Bsmt Gar # Cars		Entrance Code 0
Wet Basement		1.Interior 4.Vacant 7.Entered
1.Dry 4. 7.		2.Refusal 5.Estimate 8.No
2.Damp 5. 8.	3.Informed 6.Reviewed 9.Land	
3.Wet 6. 9.	Information Code 0	
	1.Owner 4.Agent 7.	
	2.Relative 5.Estimate 8.	
	3.Tenant 6.Other 9.	

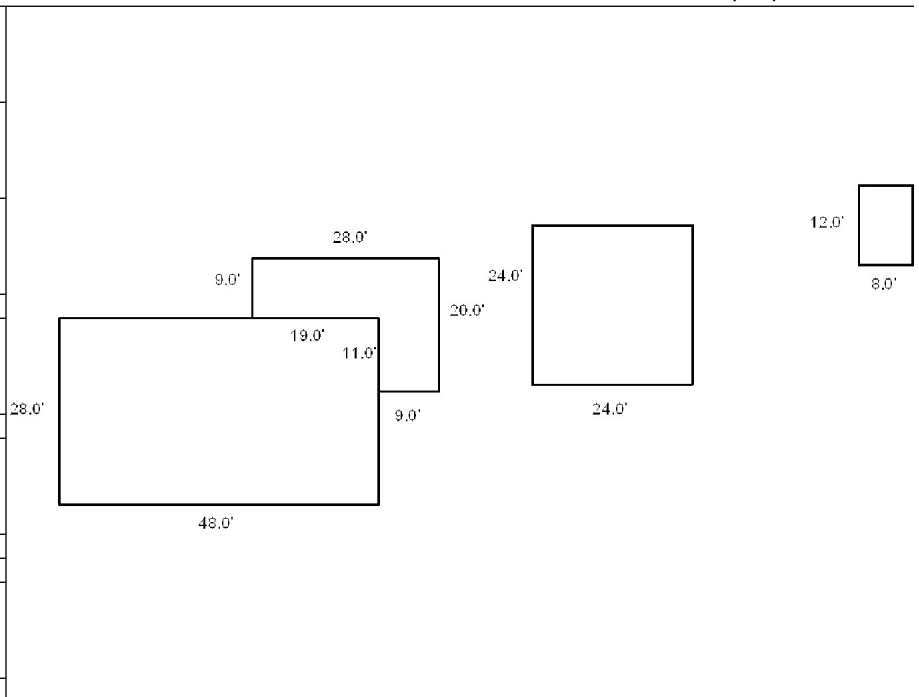

Date Inspected 4/11/2011

Additions, Outbuildings & Improvements

Type	Year	Units	Grade	Cond	Phys.	Funct.	Sound Value
68 Wood Deck	1997	351	3 100	3	0 %	100 %	
30 Detached Garage	2000	576	3 100	3	0 %	100 %	
24 Frame Shed	1997				%	%	500
992 Doublewide	1993	28x52	3 100	3	0 %	100 %	
97 Slab for MoHo	1993	1344	3 100	3	0 %	100 %	
73 M/H Skirting	1993	152	3 100	3	0 %	100 %	
49 Storage space	2000	283	3 100	3	0 %	100 %	
					%	%	
					%	%	
					%	%	



- 1.One Story Fram
- 2.Two Story Fram
- 3.Three Story Fr
- 4.1 & 1/2 Story
- 5.1 & 3/4 Story
- 6.2 & 1/2 Story
- 21.Open Frame Por
- 22.Encl Frame Por
- 23.Attached Garag
- 24.Frame Shed
- 25.Frame Bay Wind
- 26.1SFr Overhang
- 27.Unfin Basement
- 28.Unfinished Att
- 29.Finished Attic

Bowdoin

Map Lot 09-28-0

Account 965

Location 483 WEST RD

Card 1 Of 1 7/19/2022

Building Style 5 Garrison	SF Bsmt Living 0	Layout 1 Typical
0.Not Code 4.Cape 8.Log	Fin Bsmt Grade 0 0	1.Typical 4. 7.
1.Conv. 5.Garrison 9.Other	OCCUPANCY 0	2.Inadeq 5. 8.
2.Ranch 6.Split 10.DW	Heat Type 100% 8 Floor/Wall Unit	3.Poor 6. 9.
3.R Ranch 7.Contemp 11.Church	0.Not Code 4.Steam 8.F/Wall	Attic 9 None
Dwelling Units 1	1.HWBB 5.FWA 9.No Heat	1.1/4 Fin 4.Full Fin 7.
Other Units 0	2.HWCI 6.GravWA 11.	2.1/2 Fin 5.F/Stair 8.
Stories 2 Two Story	3.H Pump 7.Electric 12.	3.3/4 Fin 6. 9.None
1.1 4.1.5 7.4	Cool Type 0% 9 None	Insulation 1 Full
2.2 5.1.75 8.20	1.Refrig 4.W&C Air 7.	1.Full 4.Minimal 7.
3.3 6.2.5 9.Yurt	2.Evapor 5. 8.	2.Heavy 5. 8.
Exterior Walls 1 Wood Siding	3.H Pump 6. 9.None	3.Capped 6. 9.None
0.Not Code 4.Asbestos 8.Concrete	Kitchen Style 2 Typical	Unfinished % 0%
1.Wood 5.Stucco 9.Other	1.Modern 4.Obsolete 7.	Grade & Factor 2 Fair 110%
2.Vin/Al 6.Brick 10.Board B	2.Typical 5. 8.	1.E Grade 4.B Grade 7.
3.Compos. 7.Stone 12.	3.Old Type 6. 9.None	2.D Grade 5.A Grade 8.
Roof Surface 1 Asphalt Shingles	Bath(s) Style 2 Typical Bath(s)	3.C Grade 6.AA Grade 9.Same
1.Asphalt 4.Composit 7.	1.Modern 4.Obsolete 7.	SQFT (Footprint) 576
2.Slate 5.Wood 8.	2.Typical 5. 8.	Condition 3 Below Average
3.Metal 6.Other 9.	3.Old Type 6. 9.None	1.Poor 4.Avg 7.V G
SF Masonry Trim 0	# Rooms 8	2.Fair 5.Avg+ 8.Exc
SEPTIC DESIGN 0	# Bedrooms 3	3.Avg- 6.Good 9.Same
BLDG PERMIT 0	# Full Baths 1	Phys. % Good 0%
Year Built 1900	# Half Baths 0	Funct. % Good 81%
Year Remodeled 0	# Addn Fixtures 0	Functional Code 1 Incomplete
Foundation 3 Brick &/or Stone	# Fireplaces 0	1.Incomp 4.Delap 7.No Power
1.Concrete 4.Wood 7.		2.O-Built 5.Bsmt 8.LongTerm
2.C Block 5.Slab 8.		3.Damage 6.Dbwd 9.None
3.Br/Stone 6.Piers 9.		Econ. % Good 100%
Basement 4 Full Basement		Economic Code None
1.1/4 Bmt 4.Full Bmt 7.		0.None 3.No Power 7.
2.1/2 Bmt 5.None 8.		1.Location 4.Generate 8.
3.3/4 Bmt 6. 9.None		2.Encroach 9.None 9.
Bsmt Gar # Cars 0		Entrance Code 0
Wet Basement 3 Wet Basement		1.Interior 4.Vacant 7.Entered
1.Dry 4. 7.		2.Refusal 5.Estimate 8.No
2.Damp 5. 8.	3.Informed 6.Reviewed 9.Land	
3.Wet 6. 9.	Information Code 0	
	1.Owner 4.Agent 7.	
	2.Relative 5.Estimate 8.	
	3.Tenant 6.Other 9.	

Date Inspected

Additions, Outbuildings & Improvements

Type	Year	Units	Grade	Cond	Phys.	Funct.	Sound Value
11 One	1958	1024	2 110	3	0 %	85 %	
29 Finished Attic	1958	512	2 110	3	0 %	85 %	
21 Open Frame	1958	48	2 110	3	0 %	100 %	
					%	%	
					%	%	
					%	%	
					%	%	
					%	%	
					%	%	
					%	%	
					%	%	

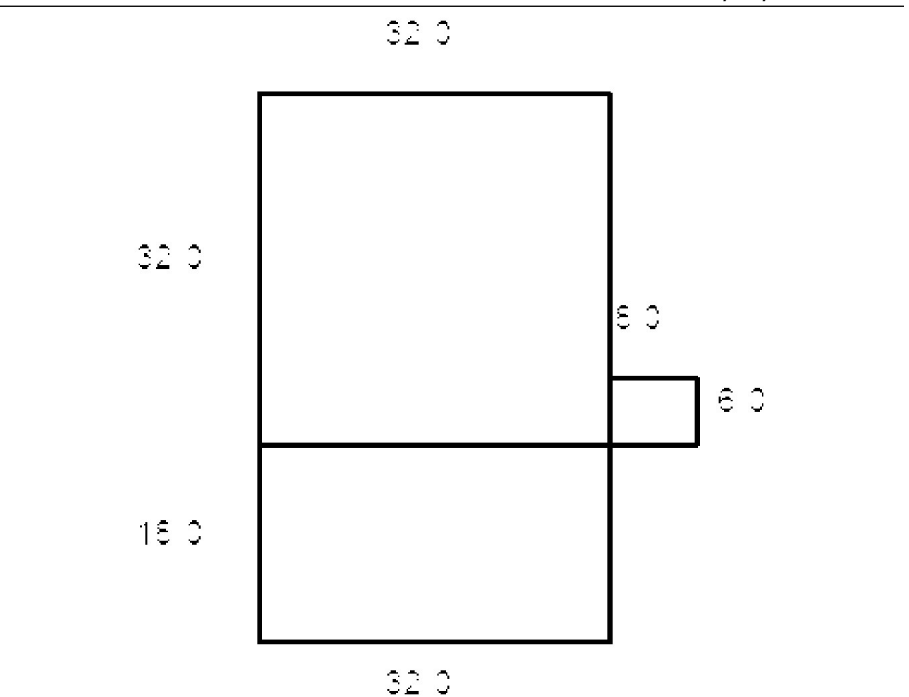

DWYER, NORRIS J
 DWYER, CHERYL L
 490 WEST RD
 BOWDOIN ME 04287

B1466P217

			Property Data			Assessment Record																																																																																																																																																																																																																	
			Neighborhood	9 Map 9		Year	Land	Buildings	Exempt	Total																																																																																																																																																																																																													
			Tree Growth Year 0			2009	128,800	223,090	16,000	335,890																																																																																																																																																																																																													
			Farmland Yr 0			2010	128,800	223,090	16,000	335,890																																																																																																																																																																																																													
			Open Space Yr 0			2011	137,800	223,090	16,000	344,890																																																																																																																																																																																																													
			Zone/Land Use 11 Residential 1			2012	137,800	223,090	16,000	344,890																																																																																																																																																																																																													
			Secondary Zone			2013	128,800	223,090	16,000	335,890																																																																																																																																																																																																													
			Topography			2014	128,800	223,090	16,000	335,890																																																																																																																																																																																																													
			1.Level 4.Below St 7.LevelBog			2015	128,800	223,090	16,000	335,890																																																																																																																																																																																																													
			2.Rolling 5.Low 8.Conform			2016	128,800	223,090	21,000	330,890																																																																																																																																																																																																													
			3.Above St 6.FZone 9.Non-Confor			2017	128,800	223,090	26,000	325,890																																																																																																																																																																																																													
			Utilities			2018	128,800	223,090	26,000	325,890																																																																																																																																																																																																													
			1.Public 4.Dr Well 7.Cesspool			2019	128,800	223,090	26,000	325,890																																																																																																																																																																																																													
			2.Water 5.Dug Well 8.			2020	128,800	223,090	31,000	320,890																																																																																																																																																																																																													
			3.Sewer 6.Septic 9.None			2021	128,800	223,090	31,000	320,890																																																																																																																																																																																																													
			Street 1 Paved			2022	128,800	211,390	26,660	313,530																																																																																																																																																																																																													
			1.Paved 4.Proposed 7.MHG			<table border="1"> <thead> <tr> <th colspan="5">Land Data</th> </tr> <tr> <th rowspan="2">Front Foot</th> <th rowspan="2">Type</th> <th colspan="2">Effective</th> <th colspan="2">Influence</th> <th rowspan="2">Influence Codes</th> </tr> <tr> <th>Frontage</th> <th>Depth</th> <th>Factor</th> <th>Code</th> </tr> </thead> <tbody> <tr> <td>11.Road Frontage</td> <td></td> <td></td> <td></td> <td>%</td> <td></td> <td>1.Unimproved</td> </tr> <tr> <td>12.Delta Triangle</td> <td></td> <td></td> <td></td> <td>%</td> <td></td> <td>2.Excess Frtg</td> </tr> <tr> <td>13.Nabla Triangle</td> <td></td> <td></td> <td></td> <td>%</td> <td></td> <td>3.Topography</td> </tr> <tr> <td>14.Rear Land</td> <td></td> <td></td> <td></td> <td>%</td> <td></td> <td>4.Size/Shape</td> </tr> <tr> <td>15.Miscellaneous</td> <td></td> <td></td> <td></td> <td>%</td> <td></td> <td>5.Access</td> </tr> <tr> <td></td> <td></td> <td></td> <td></td> <td>%</td> <td></td> <td>6.Restriction</td> </tr> <tr> <td></td> <td></td> <td></td> <td></td> <td>%</td> <td></td> <td>7.Open Space</td> </tr> <tr> <td></td> <td></td> <td></td> <td></td> <td>%</td> <td></td> <td>8.View/Environ</td> </tr> <tr> <td></td> <td></td> <td></td> <td></td> <td>%</td> <td></td> <td>9.Fract Share</td> </tr> <tr> <td></td> <td></td> <td></td> <td></td> <td>%</td> <td></td> <td>Acres</td> </tr> <tr> <td></td> <td></td> <td></td> <td></td> <td>%</td> <td></td> <td>30.Rear Land 3</td> </tr> <tr> <td></td> <td></td> <td></td> <td></td> <td>%</td> <td></td> <td>31.Tillable</td> </tr> <tr> <td></td> <td></td> <td></td> <td></td> <td>%</td> <td></td> <td>32.Pasture</td> </tr> <tr> <td></td> <td></td> <td></td> <td></td> <td>%</td> <td></td> <td>33.Orchard</td> </tr> <tr> <td></td> <td></td> <td></td> <td></td> <td>%</td> <td></td> <td>34.Softwood F&O</td> </tr> <tr> <td></td> <td></td> <td></td> <td></td> <td>%</td> <td></td> <td>35.Mixed Wood F&O</td> </tr> <tr> <td></td> <td></td> <td></td> <td></td> <td>%</td> <td></td> <td>36.Hardwood F&O</td> </tr> <tr> <td></td> <td></td> <td></td> <td></td> <td>%</td> <td></td> <td>37.Softwood TG</td> </tr> <tr> <td></td> <td></td> <td></td> <td></td> <td>%</td> <td></td> <td>38.Mixed Wood TG</td> </tr> <tr> <td></td> <td></td> <td></td> <td></td> <td>%</td> <td></td> <td>39.Hardwood TG</td> </tr> <tr> <td></td> <td></td> <td></td> <td></td> <td>%</td> <td></td> <td>40.Wasteland</td> </tr> <tr> <td></td> <td></td> <td></td> <td></td> <td>%</td> <td></td> <td>41.Commercial</td> </tr> <tr> <td></td> <td></td> <td></td> <td></td> <td>%</td> <td></td> <td>42.2nd Site</td> </tr> <tr> <td></td> <td></td> <td></td> <td></td> <td>%</td> <td></td> <td>43.Post Rd</td> </tr> <tr> <td></td> <td></td> <td></td> <td></td> <td>%</td> <td></td> <td>44.Lot Improvemen</td> </tr> <tr> <td></td> <td></td> <td></td> <td></td> <td>%</td> <td></td> <td>45.Subdivision Lo</td> </tr> <tr> <td></td> <td></td> <td></td> <td></td> <td>%</td> <td></td> <td>46.Golf Course</td> </tr> </tbody> </table>					Land Data					Front Foot	Type	Effective		Influence		Influence Codes	Frontage	Depth	Factor	Code	11.Road Frontage				%		1.Unimproved	12.Delta Triangle				%		2.Excess Frtg	13.Nabla Triangle				%		3.Topography	14.Rear Land				%		4.Size/Shape	15.Miscellaneous				%		5.Access					%		6.Restriction					%		7.Open Space					%		8.View/Environ					%		9.Fract Share					%		Acres					%		30.Rear Land 3					%		31.Tillable					%		32.Pasture					%		33.Orchard					%		34.Softwood F&O					%		35.Mixed Wood F&O					%		36.Hardwood F&O					%		37.Softwood TG					%		38.Mixed Wood TG					%		39.Hardwood TG					%		40.Wasteland					%		41.Commercial					%		42.2nd Site					%		43.Post Rd					%		44.Lot Improvemen					%		45.Subdivision Lo					%		46.Golf Course
			Land Data																																																																																																																																																																																																																				
Front Foot	Type	Effective		Influence		Influence Codes																																																																																																																																																																																																																	
		Frontage	Depth	Factor	Code																																																																																																																																																																																																																		
11.Road Frontage				%		1.Unimproved																																																																																																																																																																																																																	
12.Delta Triangle				%		2.Excess Frtg																																																																																																																																																																																																																	
13.Nabla Triangle				%		3.Topography																																																																																																																																																																																																																	
14.Rear Land				%		4.Size/Shape																																																																																																																																																																																																																	
15.Miscellaneous				%		5.Access																																																																																																																																																																																																																	
				%		6.Restriction																																																																																																																																																																																																																	
				%		7.Open Space																																																																																																																																																																																																																	
				%		8.View/Environ																																																																																																																																																																																																																	
				%		9.Fract Share																																																																																																																																																																																																																	
				%		Acres																																																																																																																																																																																																																	
				%		30.Rear Land 3																																																																																																																																																																																																																	
				%		31.Tillable																																																																																																																																																																																																																	
				%		32.Pasture																																																																																																																																																																																																																	
				%		33.Orchard																																																																																																																																																																																																																	
				%		34.Softwood F&O																																																																																																																																																																																																																	
				%		35.Mixed Wood F&O																																																																																																																																																																																																																	
				%		36.Hardwood F&O																																																																																																																																																																																																																	
				%		37.Softwood TG																																																																																																																																																																																																																	
				%		38.Mixed Wood TG																																																																																																																																																																																																																	
				%		39.Hardwood TG																																																																																																																																																																																																																	
				%		40.Wasteland																																																																																																																																																																																																																	
				%		41.Commercial																																																																																																																																																																																																																	
				%		42.2nd Site																																																																																																																																																																																																																	
				%		43.Post Rd																																																																																																																																																																																																																	
				%		44.Lot Improvemen																																																																																																																																																																																																																	
				%		45.Subdivision Lo																																																																																																																																																																																																																	
				%		46.Golf Course																																																																																																																																																																																																																	
			TG PLAN YEAR 0			<table border="1"> <thead> <tr> <th colspan="2">Square Foot</th> <th colspan="2">Square Feet</th> <th colspan="2">Acres/Sites</th> </tr> </thead> <tbody> <tr> <td>24</td> <td></td> <td>1.00</td> <td></td> <td>100</td> <td>% 0</td> </tr> <tr> <td>28</td> <td></td> <td>25.00</td> <td></td> <td>100</td> <td>% 0</td> </tr> <tr> <td>29</td> <td></td> <td>25.00</td> <td></td> <td>100</td> <td>% 0</td> </tr> <tr> <td>40</td> <td></td> <td>7.20</td> <td></td> <td>100</td> <td>% 0</td> </tr> <tr> <td>49</td> <td></td> <td>3.40</td> <td></td> <td>100</td> <td>% 0</td> </tr> <tr> <td>44</td> <td></td> <td>1.00</td> <td></td> <td>100</td> <td>% 0</td> </tr> <tr> <td>30</td> <td></td> <td>29.40</td> <td></td> <td>100</td> <td>% 0</td> </tr> <tr> <td colspan="2">Total Acreage</td> <td colspan="2"></td> <td colspan="2">91.00</td> </tr> </tbody> </table>					Square Foot		Square Feet		Acres/Sites		24		1.00		100	% 0	28		25.00		100	% 0	29		25.00		100	% 0	40		7.20		100	% 0	49		3.40		100	% 0	44		1.00		100	% 0	30		29.40		100	% 0	Total Acreage				91.00																																																																																																																																																								
			Square Foot		Square Feet						Acres/Sites																																																																																																																																																																																																												
24		1.00		100	% 0																																																																																																																																																																																																																		
28		25.00		100	% 0																																																																																																																																																																																																																		
29		25.00		100	% 0																																																																																																																																																																																																																		
40		7.20		100	% 0																																																																																																																																																																																																																		
49		3.40		100	% 0																																																																																																																																																																																																																		
44		1.00		100	% 0																																																																																																																																																																																																																		
30		29.40		100	% 0																																																																																																																																																																																																																		
Total Acreage				91.00																																																																																																																																																																																																																			
			Tif District # 0																																																																																																																																																																																																																				
			Sale Data																																																																																																																																																																																																																				
			Sale Date																																																																																																																																																																																																																				
			Price																																																																																																																																																																																																																				
			Sale Type																																																																																																																																																																																																																				
			1.Land 4.Mobile 7.C/I L&B																																																																																																																																																																																																																				
			2.L & B 5.Other 8.																																																																																																																																																																																																																				
			3.Building 6.C/I Land 9.																																																																																																																																																																																																																				
			Financing																																																																																																																																																																																																																				
			1.Convent 4.Seller 7.																																																																																																																																																																																																																				
			2.FHA/VA 5.Private 8.																																																																																																																																																																																																																				
			3.Assumed 6.Cash 9.Unknown																																																																																																																																																																																																																				
			Validity																																																																																																																																																																																																																				
			1.Valid 4.Split 7.Renovate																																																																																																																																																																																																																				
			2.Related 5.Partial 8.Other																																																																																																																																																																																																																				
			3.Distress 6.Exempt 9.Short																																																																																																																																																																																																																				
			Verified																																																																																																																																																																																																																				
			1.Buyer 4.Agent 7.Family																																																																																																																																																																																																																				
			2.Seller 5.Pub Rec 8.Other																																																																																																																																																																																																																				
			3.Lender 6.MLS 9.																																																																																																																																																																																																																				

Inspection Witnessed By:

X	Date	Description	Date Insp.

Notes:

Bowdoin

Bowdoin

Map Lot 09-29-0

Account 966

Location 490 WEST RD

Card 1 Of 2 7/19/2022

Building Style 2 Ranch	SF Bsmt Living 0	Layout 1 Typical
0.Not Code 4.Cape 8.Log	Fin Bsmt Grade 0 0	1.Typical 4. 7.
1.Conv. 5.Garrison 9.Other	OCCUPANCY 0	2.Inadeq 5. 8.
2.Ranch 6.Split 10.DW	Heat Type 100% 5 Forced Warm Air	3.Poor 6. 9.
3.R Ranch 7.Contemp 11.Church	0.Not Code 4.Steam 8.F/Wall	Attic 9 None
Dwelling Units 1	1.HWBB 5.FWA 9.No Heat	1.1/4 Fin 4.Full Fin 7.
Other Units 0	2.HWCI 6.GravWA 11.	2.1/2 Fin 5.F/Stair 8.
Stories 1 One Story	3.H Pump 7.Electric 12.	3.3/4 Fin 6. 9.None
1.1 4.1.5 7.4	Cool Type 0% 9 None	Insulation 1 Full
2.2 5.1.75 8.20	1.Refrig 4.W&C Air 7.	1.Full 4.Minimal 7.
3.3 6.2.5 9.Yurt	2.Evapor 5. 8.	2.Heavy 5. 8.
Exterior Walls 1 Wood Siding	3.H Pump 6. 9.None	3.Capped 6. 9.None
0.Not Code 4.Asbestos 8.Concrete	Kitchen Style 2 Typical	Unfinished % 0%
1.Wood 5.Stucco 9.Other	1.Modern 4.Obsolete 7.	Grade & Factor 4 Good 100%
2.Vin/Al 6.Brick 10.Board B	2.Typical 5. 8.	1.E Grade 4.B Grade 7.
3.Compos. 7.Stone 12.	3.Old Type 6. 9.None	2.D Grade 5.A Grade 8.
Roof Surface 1 Asphalt Shingles	Bath(s) Style 2 Typical Bath(s)	3.C Grade 6.AA Grade 9.Same
1.Asphalt 4.Composit 7.	1.Modern 4.Obsolete 7.	SQFT (Footprint) 1632
2.Slate 5.Wood 8.	2.Typical 5. 8.	Condition 4 Average
3.Metal 6.Other 9.	3.Old Type 6. 9.None	1.Poor 4.Avg 7.V G
SF Masonry Trim 0	# Rooms 6	2.Fair 5.Avg+ 8.Exc
SEPTIC DESIGN 0	# Bedrooms 3	3.Avg- 6.Good 9.Same
BLDG PERMIT 0	# Full Baths 2	Phys. % Good 0%
Year Built 1971	# Half Baths 0	Funct. % Good 100%
Year Remodeled 0	# Addn Fixtures 0	Functional Code 9 None
Foundation 1 Concrete	# Fireplaces 0	1.Incomp 4.Delap 7.No Power
1.Concrete 4.Wood 7.		2.O-Built 5.Bsmt 8.LongTerm
2.C Block 5.Slab 8.		3.Damage 6.Dbwd 9.None
3.Br/Stone 6.Piers 9.		Econ. % Good 100%
Basement 4 Full Basement		Economic Code None
1.1/4 Bmt 4.Full Bmt 7.		0.None 3.No Power 7.
2.1/2 Bmt 5.None 8.		1.Location 4.Generate 8.
3.3/4 Bmt 6. 9.None		2.Encroach 9.None 9.
Bsmt Gar # Cars 0		Entrance Code 0
Wet Basement 1 Dry Basement		1.Interior 4.Vacant 7.Entered
1.Dry 4. 7.		2.Refusal 5.Estimate 8.No
2.Damp 5. 8.	3.Informed 6.Reviewed 9.Land	
3.Wet 6. 9.	Information Code 0	
	1.Owner 4.Agent 7.	
	2.Relative 5.Estimate 8.	
	3.Tenant 6.Other 9.	

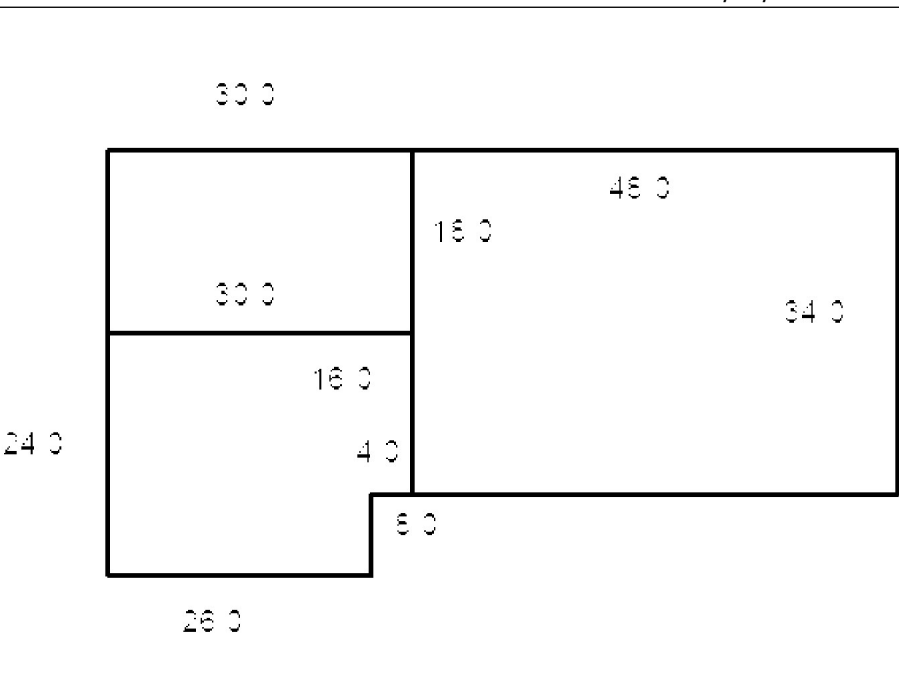

Date Inspected

Additions, Outbuildings & Improvements

Type	Year	Units	Grade	Cond	Phys.	Funct.	Sound Value
68 Wood Deck	2000	540	3 100	4	0 %	100 %	
23 Attached Garage	1971	688	3 100	4	0 %	100 %	
30 Detached Garage	1985	936	3 100	4	0 %	100 %	
30 Detached Garage	1993	864	3 100	4	0 %	100 %	
49 Storage space	1985	468	3 100	4	0 %	100 %	
					%	%	
					%	%	
					%	%	
					%	%	
					%	%	
					%	%	



- 1.One Story Fram
- 2.Two Story Fram
- 3.Three Story Fr
- 4.1 & 1/2 Story
- 5.1 & 3/4 Story
- 6.2 & 1/2 Story
- 21.Open Frame Por
- 22.Encl Frame Por
- 23.Attached Garag
- 24.Frame Shed
- 25.Frame Bay Wind
- 26.1SFr Overhang
- 27.Unfin Basement
- 28.Unfinished Att
- 29.Finished Attic

Bowdoin

Map Lot 09-29-01

Account 967

Location 540 WEST RD

Card 1 Of 1 7/19/2022

Building Style 2 Ranch	SF Bsmt Living 0	Layout 1 Typical
0.Not Code 4.Cape 8.Log	Fin Bsmt Grade 0 0	1.Typical 4. 7.
1.Conv. 5.Garrison 9.Other	OCCUPANCY 0	2.Inadeq 5. 8.
2.Ranch 6.Split 10.DW	Heat Type 100% 5 Forced Warm Air	3.Poor 6. 9.
3.R Ranch 7.Contemp 11.Church	0.Not Code 4.Steam 8.FI/Wall	Attic 9 None
Dwelling Units 1	1.HWBB 5.FWA 9.No Heat	1.1/4 Fin 4.Full Fin 7.
Other Units 0	2.HWCI 6.GravWA 11.	2.1/2 Fin 5.FI/Stair 8.
Stories 1 One Story	3.H Pump 7.Electric 12.	3.3/4 Fin 6. 9.None
1.1 4.1.5 7.4	Cool Type 0% 9 None	Insulation 1 Full
2.2 5.1.75 8.20	1.Refrig 4.W&C Air 7.	1.Full 4.Minimal 7.
3.3 6.2.5 9.Yurt	2.Evapor 5. 8.	2.Heavy 5. 8.
Exterior Walls 2 Vinyl/Aluminum	3.H Pump 6. 9.None	3.Capped 6. 9.None
0.Not Code 4.Asbestos 8.Concrete	Kitchen Style 2 Typical	Unfinished % 0%
1.Wood 5.Stucco 9.Other	1.Modern 4.Obsolete 7.	Grade & Factor 3 Average 110%
2.Vin/Al 6.Brick 10.Board B	2.Typical 5. 8.	1.E Grade 4.B Grade 7.
3.Compos. 7.Stone 12.	3.Old Type 6. 9.None	2.D Grade 5.A Grade 8.
Roof Surface 1 Asphalt Shingles	Bath(s) Style 2 Typical Bath(s)	3.C Grade 6.AA Grade 9.Same
1.Asphalt 4.Composit 7.	1.Modern 4.Obsolete 7.	SQFT (Footprint) 1587
2.Slate 5.Wood 8.	2.Typical 5. 8.	Condition 4 Average
3.Metal 6.Other 9.	3.Old Type 6. 9.None	1.Poor 4.Avg 7.V G
SF Masonry Trim 0	# Rooms 6	2.Fair 5.Avg+ 8.Exc
SEPTIC DESIGN 0	# Bedrooms 3	3.Avg- 6.Good 9.Same
BLDG PERMIT 0	# Full Baths 1	Phys. % Good 0%
Year Built 2002	# Half Baths 1	Funct. % Good 95%
Year Remodeled 0	# Addn Fixtures 0	Functional Code 9 None
Foundation 1 Concrete	# Fireplaces 0	1.Incomp 4.Delap 7.No Power
1.Concrete 4.Wood 7.	 <p>TRIO Software A Division of Harris Computer Systems</p>	2.O-Built 5.Bsmt 8.LongTerm
2.C Block 5.Slab 8.		3.Damage 6.Dbwd 9.None
3.Br/Stone 6.Piers 9.		Econ. % Good 100%
Basement 4 Full Basement		Economic Code None
1.1/4 Bmt 4.Full Bmt 7.		0.None 3.No Power 7.
2.1/2 Bmt 5.None 8.		1.Location 4.Generate 8.
3.3/4 Bmt 6. 9.None		2.Encroach 9.None 9.
Bsmt Gar # Cars 0		Entrance Code 0
Wet Basement 3 Wet Basement		1.Interior 4.Vacant 7.Entered
1.Dry 4. 7.		2.Refusal 5.Estimate 8.No
2.Damp 5. 8.	3.Informed 6.Reviewed 9.Land	
3.Wet 6. 9.	Information Code 0	
	1.Owner 4.Agent 7.	
	2.Relative 5.Estimate 8.	
	3.Tenant 6.Other 9.	

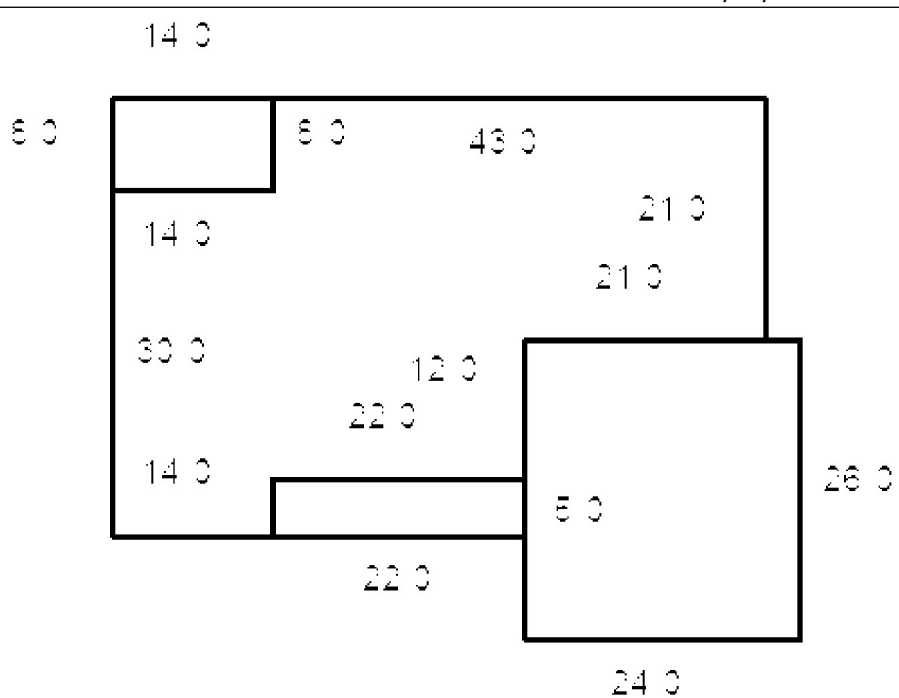

Date Inspected

Additions, Outbuildings & Improvements

Type	Year	Units	Grade	Cond	Phys.	Funct.	Sound Value
21 Open Frame	2002	112	3 110	4	0 %	95 %	
21 Open Frame	2002	110	3 110	4	0 %	95 %	
23 Attached Garage	2002	624	3 110	4	0 %	95 %	
24 Frame Shed	1992	192	2 100	4	0 %	100 %	
					%	%	
					%	%	
					%	%	
					%	%	
					%	%	
					%	%	
					%	%	



HUSTON, DOUGLAS H
 HUSTON, JENNIFER
 560 WEST RD
 BOWDOIN ME 04287

B1358P12

Inspection Witnessed By:

X		Date
No./Date	Description	Date Insp.

Notes:

Bowdoin

Property Data			Assessment Record				
Neighborhood 9 Map 9			Year	Land	Buildings	Exempt	Total
Tree Growth Year 0			2009	51,210	197,810	0	249,020
Farmland Yr 0			2010	51,210	197,810	0	249,020
Open Space Yr 0			2011	51,210	197,810	0	249,020
Zone/Land Use 11 Residential 1			2012	51,210	197,810	0	249,020
Secondary Zone			2013	51,210	197,810	0	249,020
Topography			2014	51,210	197,810	0	249,020
1.Level 4.Below St 7.LevelBog			2015	51,210	197,810	0	249,020
2.Rolling 5.Low 8.Conform			2016	51,210	197,810	0	249,020
3.Above St 6.FZone 9.Non-Confor			2017	51,210	197,810	0	249,020
Utilities			2018	51,210	197,810	0	249,020
1.Public 4.Dr Well 7.Cesspool			2019	51,210	197,810	0	249,020
2.Water 5.Dug Well 8.			2020	51,210	197,810	0	249,020
3.Sewer 6.Septic 9.None			2021	51,210	197,810	0	249,020
Street 1 Paved			2022	51,210	189,180	0	240,390
1.Paved 4.Proposed 7.MHG			Land Data				
2.Semi Imp 5.R/O/W 8.DIS							
3.Gravel 6.MHP 9.None			Front Foot				
TG PLAN YEAR 0							
Tif District # 0			Type				
Sale Data							
Sale Date			Effective				
Price							
Sale Type			Influence				
1.Land 4.Mobile 7.C/I L&B							
2.L & B 5.Other 8.			Influence Codes				
3.Building 6.C/I Land 9.							
Financing			Square Foot				
1.Convent 4.Seller 7.							
2.FHA/VA 5.Private 8.			Square Feet				
3.Assumed 6.Cash 9.Unknown							
Validity			Fract. Acre				
1.Valid 4.Split 7.Renovate							
2.Related 5.Partial 8.Other			Acres				
3.Distress 6.Exempt 9.Short							
Verified			Acres				
1.Buyer 4.Agent 7.Family							
2.Seller 5.Pub Rec 8.Other			Acres				
3.Lender 6.MLS 9.							

- 1.Unimproved
- 2.Excess Frtg
- 3.Topography
- 4.Size/Shape
- 5.Access
- 6.Restriction
- 7.Open Space
- 8.View/Environ
- 9.Fract Share
- Acres**
- 30.Rear Land 3
- 31.Tillable
- 32.Pasture
- 33.Orchard
- 34.Softwood F&O
- 35.Mixed Wood F&O
- 36.Hardwood F&O
- 37.Softwood TG
- 38.Mixed Wood TG
- 39.Hardwood TG
- 40.Wasteland
- 41.Commercial
- 42.2nd Site
- 43.Post Rd
- 44.Lot Improvemen
- 45.Subdivision Lo
- 46.Golf Course

Total Acreage 3.65

Bowdoin

Map Lot 09-29-02

Account 968

Location 560 WEST RD

Card 1 Of 1 7/19/2022

Building Style 1 Conventional	SF Bsmt Living 0	Layout 1 Typical
0.Not Code 4.Cape 8.Log	Fin Bsmt Grade 0 0	1.Typical 4. 7.
1.Conv. 5.Garrison 9.Other	OCCUPANCY 0	2.Inadeq 5. 8.
2.Ranch 6.Split 10.DW	Heat Type 100% 1 Hot Water BB	3.Poor 6. 9.
3.R Ranch 7.Contemp 11.Church	0.Not Code 4.Steam 8.FI/Wall	Attic 9 None
Dwelling Units 1	1.HWBB 5.FWA 9.No Heat	1.1/4 Fin 4.Full Fin 7.
Other Units 0	2.HWCI 6.GravWA 11.	2.1/2 Fin 5.FI/Stair 8.
Stories 2 Two Story	3.H Pump 7.Electric 12.	3.3/4 Fin 6. 9.None
1.1 4.1.5 7.4	Cool Type 0% 9 None	Insulation 1 Full
2.2 5.1.75 8.20	1.Refrig 4.W&C Air 7.	1.Full 4.Minimal 7.
3.3 6.2.5 9.Yurt	2.Evapor 5. 8.	2.Heavy 5. 8.
Exterior Walls 2 Vinyl/Aluminum	3.H Pump 6. 9.None	3.Capped 6. 9.None
0.Not Code 4.Asbestos 8.Concrete	Kitchen Style 2 Typical	Unfinished % 0%
1.Wood 5.Stucco 9.Other	1.Modern 4.Obsolete 7.	Grade & Factor 3 Average 110%
2.Vin/Al 6.Brick 10.Board B	2.Typical 5. 8.	1.E Grade 4.B Grade 7.
3.Compos. 7.Stone 12.	3.Old Type 6. 9.None	2.D Grade 5.A Grade 8.
Roof Surface 1 Asphalt Shingles	Bath(s) Style 2 Typical Bath(s)	3.C Grade 6.AA Grade 9.Same
1.Asphalt 4.Composit 7.	1.Modern 4.Obsolete 7.	SQFT (Footprint) 928
2.Slate 5.Wood 8.	2.Typical 5. 8.	Condition 4 Average
3.Metal 6.Other 9.	3.Old Type 6. 9.None	1.Poor 4.Avg 7.V G
SF Masonry Trim 0	# Rooms 6	2.Fair 5.Avg+ 8.Exc
SEPTIC DESIGN 0	# Bedrooms 3	3.Avg- 6.Good 9.Same
BLDG PERMIT 0	# Full Baths 1	Phys. % Good 0%
Year Built 2002	# Half Baths 1	Funct. % Good 100%
Year Remodeled 0	# Addn Fixtures 0	Functional Code 9 None
Foundation 1 Concrete	# Fireplaces 0	1.Incomp 4.Delap 7.No Power
1.Concrete 4.Wood 7.	 <p>TRIO Software A Division of Harris Computer Systems</p>	2.O-Built 5.Bsmt 8.LongTerm
2.C Block 5.Slab 8.		3.Damage 6.Dbwd 9.None
3.Br/Stone 6.Piers 9.		Econ. % Good 100%
Basement 4 Full Basement		Economic Code None
1.1/4 Bmt 4.Full Bmt 7.		0.None 3.No Power 7.
2.1/2 Bmt 5.None 8.		1.Location 4.Generate 8.
3.3/4 Bmt 6. 9.None		2.Encroach 9.None 9.
Bsmt Gar # Cars 0		Entrance Code 0
Wet Basement 1 Dry Basement		1.Interior 4.Vacant 7.Entered
1.Dry 4. 7.		2.Refusal 5.Estimate 8.No
2.Damp 5. 8.	3.Informed 6.Reviewed 9.Land	
3.Wet 6. 9.	Information Code 0	
	1.Owner 4.Agent 7.	
	2.Relative 5.Estimate 8.	
	3.Tenant 6.Other 9.	

Date Inspected 4/13/2009

Additions, Outbuildings & Improvements

Type	Year	Units	Grade	Cond	Phys.	Funct.	Sound Value
21 Open Frame	2002	56	3 110	4	0 %	100 %	
21 Open Frame	2002	96	3 110	4	0 %	100 %	
40 Basement Entry	2002	40	2 110	4	0 %	100 %	
30 Detached Garage	1998	768	3 100	4	0 %	100 %	
49 Storage space	1998	384	3 100	4	0 %	100 %	
					%	%	
					%	%	
					%	%	
					%	%	
					%	%	
					%	%	

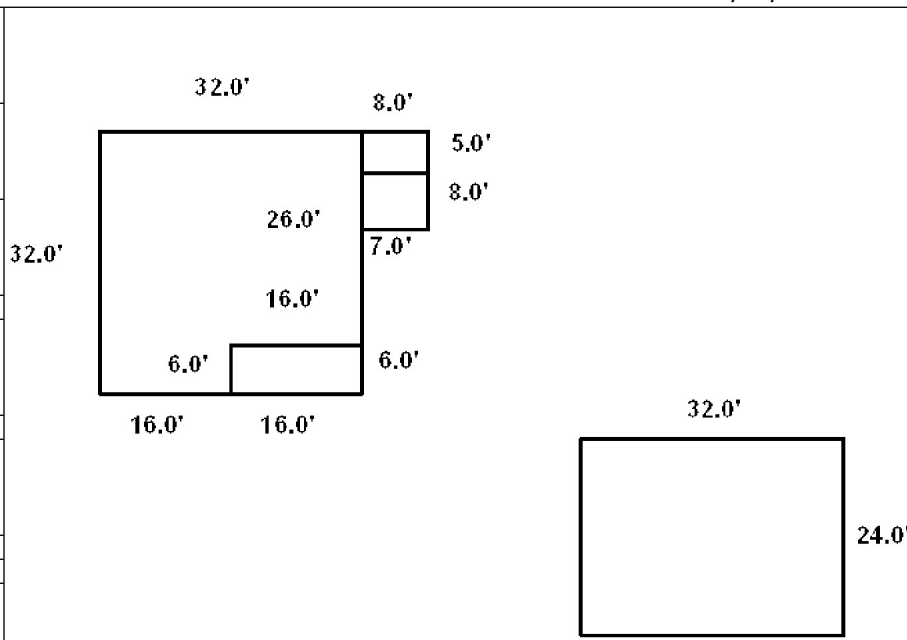

GAUTHIER, ROBERT W
 GAUTHIER, DOROTHY A
 508 WEST RD
 BOWDOIN ME 04287

B381P1087

Inspection Witnessed By:

No./Date	Description	Date Insp.
X		

Notes:

Bowdoin

Property Data			Assessment Record						
Neighborhood 9 Map 9			Year	Land	Buildings	Exempt	Total		
Tree Growth Year 0			2009	49,040	108,470	10,000	147,510		
Farmland Yr 0			2010	49,040	108,470	10,000	147,510		
Open Space Yr 0			2011	49,040	108,470	10,000	147,510		
Zone/Land Use 11 Residential 1			2012	49,040	108,470	10,000	147,510		
Secondary Zone			2013	49,040	108,470	10,000	147,510		
Topography			2014	49,040	108,470	10,000	147,510		
1.Level 4.Below St 7.LevelBog			2015	49,040	108,470	10,000	147,510		
2.Rolling 5.Low 8.Conform			2016	49,040	108,470	15,000	142,510		
3.Above St 6.FZone 9.Non-Confor			2017	49,040	108,470	20,000	137,510		
Utilities			2018	49,040	108,470	20,000	137,510		
1.Public 4.Dr Well 7.Cesspool			2019	49,040	108,470	20,000	137,510		
2.Water 5.Dug Well 8.			2020	49,040	108,470	25,000	132,510		
3.Sewer 6.Septic 9.None			2021	49,040	108,470	25,000	132,510		
Street 1 Paved			2022	49,040	102,660	21,500	130,200		
1.Paved 4.Proposed 7.MHG			Land Data						
2.Semi Imp 5.R/O/W 8.DIS									
3.Gravel 6.MHP 9.None			Front Foot	Type	Effective		Influence		Influence Codes
TG PLAN YEAR 0			11.Road Frontage		Frontage	Depth	Factor	Code	
Tif District # 0			12.Delta Triangle				%		1.Unimproved
Sale Data			13.Nabla Triangle				%		2.Excess Frtg
Sale Date			14.Rear Land				%		3.Topography
Price			15.Miscellaneous				%		4.Size/Shape
Sale Type							%		5.Access
1.Land 4.Mobile 7.C/I L&B			Square Foot	Square Feet					6.Restriction
2.L & B 5.Other 8.			16.Regular Lot				%		7.Open Space
3.Building 6.C/I Land 9.			17.Secondary Lot				%		8.View/Environ
Financing			18.Hydro Facility				%		9.Fract Share
1.Convent 4.Seller 7.			19.Improvements				%		Acres
2.FHA/VA 5.Private 8.			20.Base 3 (Fract)				%		30.Rear Land 3
3.Assumed 6.Cash 9.Unknown							%		31.Tillable
Validity			Fract. Acre	Acres/Sites					32.Pasture
1.Valid 4.Split 7.Renovate			21.Base 1 (Fract)	24	1.00	100	%	0	33.Orchard
2.Related 5.Partial 8.Other			22.Base 2 (Fract)	28	1.10	100	%	0	34.Softwood F&O
3.Distress 6.Exempt 9.Short			23.Base 3	44	1.00	100	%	0	35.Mixed Wood F&O
Verified			Acres				%		36.Hardwood F&O
1.Buyer 4.Agent 7.Family			24.Base 1				%		37.Softwood TG
2.Seller 5.Pub Rec 8.Other			25.Base 2				%		38.Mixed Wood TG
3.Lender 6.MLS 9.			26.Frontage 1				%		39.Hardwood TG
			27.Rear Land 4				%		40.Wasteland
			28.Rear Land 1				%		41.Commercial
			29.Rear Land 2				%		42.2nd Site
			Total Acreage		2.10				43.Post Rd
									44.Lot Improvemen
									45.Subdivision Lo
									46.Golf Course

Bowdoin

Map Lot 09-30-0

Account 969

Location 508 WEST RD

Card 1 Of 1 7/19/2022

Building Style 2 Ranch	SF Bsmt Living 0	Layout 1 Typical
0.Not Code 4.Cape 8.Log	Fin Bsmt Grade 0 0	1.Typical 4. 7.
1.Conv. 5.Garrison 9.Other	OCCUPANCY 0	2.Inadeq 5. 8.
2.Ranch 6.Split 10.DW	Heat Type 100% 1 Hot Water BB	3.Poor 6. 9.
3.R Ranch 7.Contemp 11.Church	0.Not Code 4.Steam 8.F/Wall	Attic 9 None
Dwelling Units 1	1.HWBB 5.FWA 9.No Heat	1.1/4 Fin 4.Full Fin 7.
Other Units 0	2.HWCI 6.GravWA 11.	2.1/2 Fin 5.F/Stair 8.
Stories 1 One Story	3.H Pump 7.Electric 12.	3.3/4 Fin 6. 9.None
1.1 4.1.5 7.4	Cool Type 0% 9 None	Insulation 1 Full
2.2 5.1.75 8.20	1.Refrig 4.W&C Air 7.	1.Full 4.Minimal 7.
3.3 6.2.5 9.Yurt	2.Evapor 5. 8.	2.Heavy 5. 8.
Exterior Walls 1 Wood Siding	3.H Pump 6. 9.None	3.Capped 6. 9.None
0.Not Code 4.Asbestos 8.Concrete	Kitchen Style 2 Typical	Unfinished % 0%
1.Wood 5.Stucco 9.Other	1.Modern 4.Obsolete 7.	Grade & Factor 3 Average 100%
2.Vin/Al 6.Brick 10.Board B	2.Typical 5. 8.	1.E Grade 4.B Grade 7.
3.Compos. 7.Stone 12.	3.Old Type 6. 9.None	2.D Grade 5.A Grade 8.
Roof Surface 1 Asphalt Shingles	Bath(s) Style 2 Typical Bath(s)	3.C Grade 6.AA Grade 9.Same
1.Asphalt 4.Composit 7.	1.Modern 4.Obsolete 7.	SQFT (Footprint) 936
2.Slate 5.Wood 8.	2.Typical 5. 8.	Condition 4 Average
3.Metal 6.Other 9.	3.Old Type 6. 9.None	1.Poor 4.Avg 7.V G
SF Masonry Trim 0	# Rooms 7	2.Fair 5.Avg+ 8.Exc
SEPTIC DESIGN 0	# Bedrooms 3	3.Avg- 6.Good 9.Same
BLDG PERMIT 0	# Full Baths 1	Phys. % Good 0%
Year Built 1964	# Half Baths 0	Funct. % Good 95%
Year Remodeled 1970	# Addn Fixtures 0	Functional Code 9 None
Foundation 1 Concrete	# Fireplaces 0	1.Incomp 4.Delap 7.No Power
1.Concrete 4.Wood 7.	 <p>TRIO Software A Division of Harris Computer Systems</p>	2.O-Built 5.Bsmt 8.LongTerm
2.C Block 5.Slab 8.		3.Damage 6.Dbwd 9.None
3.Br/Stone 6.Piers 9.		Econ. % Good 100%
Basement 4 Full Basement		Economic Code None
1.1/4 Bmt 4.Full Bmt 7.		0.None 3.No Power 7.
2.1/2 Bmt 5.None 8.		1.Location 4.Generate 8.
3.3/4 Bmt 6. 9.None		2.Encroach 9.None 9.
Bsmt Gar # Cars 0		Entrance Code 0
Wet Basement 3 Wet Basement		1.Interior 4.Vacant 7.Entered
1.Dry 4. 7.		2.Refusal 5.Estimate 8.No
2.Damp 5. 8.	3.Informed 6.Reviewed 9.Land	
3.Wet 6. 9.	Information Code 0	
	1.Owner 4.Agent 7.	
	2.Relative 5.Estimate 8.	
	3.Tenant 6.Other 9.	

380

120

260

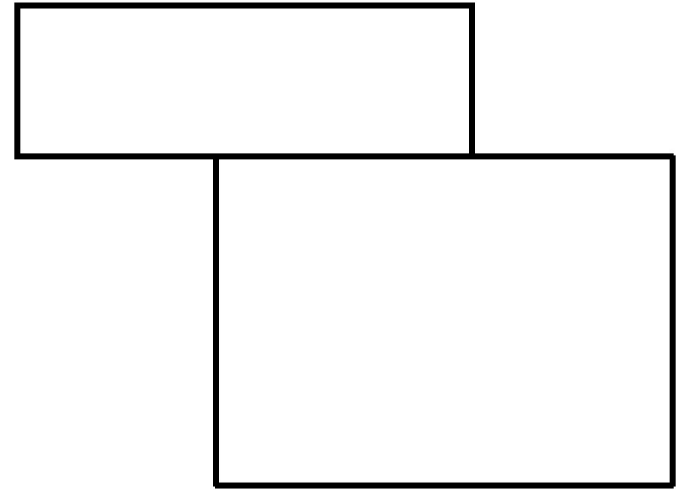

380

Date Inspected

Additions, Outbuildings & Improvements

Type	Year	Units	Grade	Cond	Phys.	Funct.	Sound Value
1 One Story Frame	2000	432	3 100	4	0 %	100 %	
30 Detached Garage	1964	576	3 100	4	0 %	100 %	
24 Frame Shed	2000	240	2 100	4	0 %	100 %	
					%	%	
					%	%	
					%	%	
					%	%	
					%	%	
					%	%	
					%	%	
					%	%	



- 1.One Story Fram
- 2.Two Story Fram
- 3.Three Story Fr
- 4.1 & 1/2 Story
- 5.1 & 3/4 Story
- 6.2 & 1/2 Story
- 21.Open Frame Por
- 22.Encl Frame Por
- 23.Attached Garag
- 24.Frame Shed
- 25.Frame Bay Wind
- 26.1SFr Overhang
- 27.Unfin Basement
- 28.Unfinished Att
- 29.Finished Attic

WHORFF, NANCY H
516 WEST RD
BOWDOIN ME 04287

B400P745

Inspection Witnessed By:

No./Date	Description	Date Insp.
X		

Notes:

Bowdoin

Property Data			Assessment Record						
Neighborhood 9 Map 9			Year	Land	Buildings	Exempt	Total		
Tree Growth Year 0			2009	48,900	49,200	16,000	82,100		
Farmland Yr 0			2010	48,900	49,200	16,000	82,100		
Open Space Yr 0			2011	48,900	49,200	16,000	82,100		
Zone/Land Use 11 Residential 1			2012	48,900	49,200	16,000	82,100		
Secondary Zone			2013	48,900	49,200	16,000	82,100		
Topography			2014	48,900	49,200	16,000	82,100		
1.Level 4.Below St 7.LevelBog			2015	48,900	49,200	16,000	82,100		
2.Rolling 5.Low 8.Conform			2016	48,900	49,200	21,000	77,100		
3.Above St 6.FZone 9.Non-Confor			2017	48,900	49,200	26,000	72,100		
Utilities			2018	48,900	49,200	26,000	72,100		
1.Public 4.Dr Well 7.Cesspool			2019	48,900	49,200	26,000	72,100		
2.Water 5.Dug Well 8.			2020	48,900	49,200	31,000	67,100		
3.Sewer 6.Septic 9.None			2021	48,900	49,200	31,000	67,100		
Street 1 Paved			2022	48,900	46,080	26,660	68,320		
1.Paved 4.Proposed 7.MHG			Land Data						
2.Semi Imp 5.R/O/W 8.DIS									
3.Gravel 6.MHP 9.None			Front Foot	Type	Effective		Influence		Influence Codes 1.Unimproved 2.Excess Frtg 3.Topography 4.Size/Shape 5.Access 6.Restriction 7.Open Space 8.View/Environ 9.Fract Share Acres 30.Rear Land 3 31.Tillable 32.Pasture 33.Orchard 34.Softwood F&O 35.Mixed Wood F&O 36.Hardwood F&O 37.Softwood TG 38.Mixed Wood TG 39.Hardwood TG 40.Wasteland 41.Commercial 42.2nd Site 43.Post Rd 44.Lot Improvemen 45.Subdivision Lo 46.Golf Course
TG PLAN YEAR 0			11.Road Frontage		Frontage	Depth	Factor	Code	
Tif District # 0			12.Delta Triangle				%		
Sale Data			13.Nabla Triangle				%		
Sale Date			14.Rear Land				%		
Price			15.Miscellaneous				%		
Sale Type							%		
1.Land 4.Mobile 7.C/I L&B			Square Foot	Square Feet					
2.L & B 5.Other 8.			16.Regular Lot				%		
3.Building 6.C/I Land 9.			17.Secondary Lot				%		
Financing			18.Hydro Facility				%		
1.Convent 4.Seller 7.			19.Improvements				%		
2.FHA/VA 5.Private 8.			20.Base 3 (Fract)				%		
3.Assumed 6.Cash 9.Unknown							%		
Validity			Fract. Acre	Acres/Sites					
1.Valid 4.Split 7.Renovate			21.Base 1 (Fract)	24	1.00	100	%	0	
2.Related 5.Partial 8.Other			22.Base 2 (Fract)	28	1.00	100	%	0	
3.Distress 6.Exempt 9.Short			23.Base 3	44	1.00	100	%	0	
Verified			Acres				%		
1.Buyer 4.Agent 7.Family			24.Base 1				%		
2.Seller 5.Pub Rec 8.Other			25.Base 2				%		
3.Lender 6.MLS 9.			26.Frontage 1				%		
			27.Rear Land 4				%		
			28.Rear Land 1				%		
			29.Rear Land 2				%		
			Total Acreage 2.00						

Bowdoin

Map Lot 09-31-0

Account 970

Location 516 WEST RD

Card 1 Of 1 7/19/2022

Building Style 0 Not Coded	SF Bsmt Living 0	Layout 0
0.Not Code 4.Cape 8.Log	Fin Bsmt Grade 0 0	1.Typical 4. 7.
1.Conv. 5.Garrison 9.Other	OCCUPANCY 0	2.Inadeq 5. 8.
2.Ranch 6.Split 10.DW	Heat Type 100% 0 Not Coded	3.Poor 6. 9.
3.R Ranch 7.Contemp 11.Church	0.Not Code 4.Steam 8.F/Wall	Attic 0
Dwelling Units 0	1.HWBB 5.FWA 9.No Heat	1.1/4 Fin 4.Full Fin 7.
Other Units 0	2.HWCI 6.GravWA 11.	2.1/2 Fin 5.F/Stair 8.
Stories 0	3.H Pump 7.Electric 12.	3.3/4 Fin 6. 9.None
1.1 4.1.5 7.4	Cool Type 0% 9 None	Insulation 0
2.2 5.1.75 8.20	1.Refrig 4.W&C Air 7.	1.Full 4.Minimal 7.
3.3 6.2.5 9.Yurt	2.Evapor 5. 8.	2.Heavy 5. 8.
Exterior Walls 0 Not Coded	3.H Pump 6. 9.None	3.Capped 6. 9.None
0.Not Code 4.Asbestos 8.Concrete	Kitchen Style 0	Unfinished % 0%
1.Wood 5.Stucco 9.Other	1.Modern 4.Obsolete 7.	Grade & Factor 0 0%
2.Vin/Al 6.Brick 10.Board B	2.Typical 5. 8.	1.E Grade 4.B Grade 7.
3.Compos. 7.Stone 12.	3.Old Type 6. 9.None	2.D Grade 5.A Grade 8.
Roof Surface 0	Bath(s) Style 0	3.C Grade 6.AA Grade 9.Same
1.Asphalt 4.Composit 7.	1.Modern 4.Obsolete 7.	SQFT (Footprint) 0
2.Slate 5.Wood 8.	2.Typical 5. 8.	Condition 0
3.Metal 6.Other 9.	3.Old Type 6. 9.None	1.Poor 4.Avg 7.V G
SF Masonry Trim 0	# Rooms 0	2.Fair 5.Avg+ 8.Exc
SEPTIC DESIGN 0	# Bedrooms 0	3.Avg- 6.Good 9.Same
BLDG PERMIT 0	# Full Baths 0	Phys. % Good 0%
Year Built 0	# Half Baths 0	Funct. % Good 100%
Year Remodeled 0	# Addn Fixtures 0	Functional Code 9 None
Foundation 0	# Fireplaces 0	1.Incomp 4.Delap 7.No Power
1.Concrete 4.Wood 7.		2.O-Built 5.Bsmt 8.LongTerm
2.C Block 5.Slab 8.		3.Damage 6.Dbwd 9.None
3.Br/Stone 6.Piers 9.		Econ. % Good 100%
Basement 0		Economic Code None
1.1/4 Bmt 4.Full Bmt 7.		0.None 3.No Power 7.
2.1/2 Bmt 5.None 8.		1.Location 4.Generate 8.
3.3/4 Bmt 6. 9.None		2.Encroach 9.None 9.
Bsmt Gar # Cars 0		Entrance Code 0
Wet Basement 0		1.Interior 4.Vacant 7.Entered
1.Dry 4. 7.		2.Refusal 5.Estimate 8.No
2.Damp 5. 8.	3.Informed 6.Reviewed 9.Land	
3.Wet 6. 9.	Information Code 0	
	1.Owner 4.Agent 7.	
	2.Relative 5.Estimate 8.	
	3.Tenant 6.Other 9.	

Date Inspected 4/28/2009

Additions, Outbuildings & Improvements

Type	Year	Units	Grade	Cond	Phys.	Funct.	Sound Value
996 10Mobile Home	1963	10x50	2 100	3	0 %	100 %	
1 One Story Frame	1990	360	2 100	3	0 %	100 %	
21 Open Frame	1990	96	2 100	3	0 %	100 %	
68 Wood Deck	1990	40	2 100	3	0 %	100 %	
30 Detached Garage	1990	560	2 100	3	0 %	100 %	
30 Detached Garage	1994	640	2 100	3	0 %	100 %	
24 Frame Shed	1990	120	2 100	3	0 %	100 %	
					%	%	
					%	%	
					%	%	

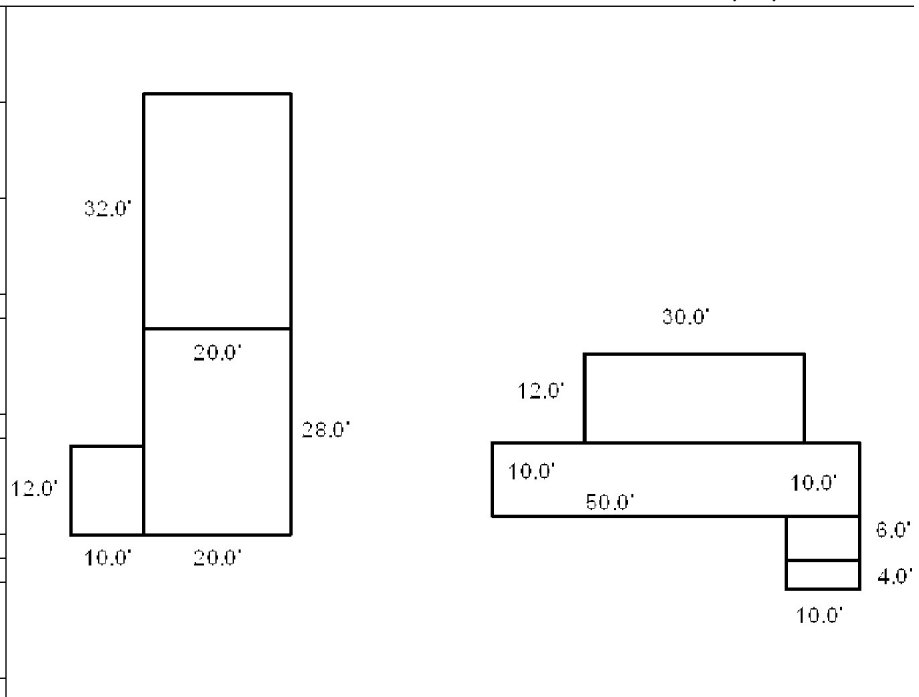

WEBBER & SONS INC, R. A.
P.O. BOX 539
HARPSWELL ME 04079

B1355P304

Inspection Witnessed By:

X		Date
No./Date	Description	Date Insp.

Notes:

Bowdoin

Property Data			Assessment Record				
Neighborhood 9 Map 9			Year	Land	Buildings	Exempt	Total
Tree Growth Year 0			2009	100,780	0	0	100,780
Farmland Yr 0			2010	100,780	0	0	100,780
Open Space Yr 0			2011	100,780	0	0	100,780
Zone/Land Use 11 Residential 1			2012	100,780	0	0	100,780
Secondary Zone			2013	100,780	0	0	100,780
Topography 6 Flood Zone			2014	100,780	0	0	100,780
1.Level 4.Below St 7.LevelBog			2015	100,780	0	0	100,780
2.Rolling 5.Low 8.Conform			2016	100,780	0	0	100,780
3.Above St 6.FZone 9.Non-Confor			2017	100,780	0	0	100,780
Utilities			2018	100,780	0	0	100,780
1.Public 4.Dr Well 7.Cesspool			2019	100,780	0	0	100,780
2.Water 5.Dug Well 8.			2020	100,780	0	0	100,780
3.Sewer 6.Septic 9.None			2021	100,780	0	0	100,780
Street			2022	100,780	0	0	100,780
1.Paved 4.Proposed 7.MHG			Land Data				
2.Semi Imp 5.R/O/W 8.DIS							
3.Gravel 6.MHP 9.None			Front Foot				
TG PLAN YEAR 0							
Tif District # 0			Square Foot				
Sale Data							
Sale Date			Fract. Acre				
Price							
Sale Type			Acres				
1.Land 4.Mobile 7.C/I L&B							
2.L & B 5.Other 8.			Fract. Acre				
3.Building 6.C/I Land 9.							
Financing			Acres				
1.Convent 4.Seller 7.							
2.FHA/VA 5.Private 8.			Fract. Acre				
3.Assumed 6.Cash 9.Unknown							
Validity			Acres				
1.Valid 4.Split 7.Renovate							
2.Related 5.Partial 8.Other			Acres				
3.Distress 6.Exempt 9.Short							
Verified			Acres				
1.Buyer 4.Agent 7.Family							
2.Seller 5.Pub Rec 8.Other			Acres				
3.Lender 6.MLS 9.							

Type	Effective		Influence		Influence Codes
	Frontage	Depth	Factor	Code	
11.Road Frontage			%		1.Unimproved
12.Delta Triangle			%		2.Excess Frtg
13.Nabla Triangle			%		3.Topography
14.Rear Land			%		4.Size/Shape
15.Miscellaneous			%		5.Access
			%		6.Restriction
			%		7.Open Space
			%		8.View/Environ
			%		9.Fract Share
			%		Acres
			%		30.Rear Land 3
			%		31.Tillable
			%		32.Pasture
			%		33.Orchard
			%		34.Softwood F&O
			%		35.Mixed Wood F&O
			%		36.Hardwood F&O
			%		37.Softwood TG
			%		38.Mixed Wood TG
			%		39.Hardwood TG
			%		40.Wasteland
			%		41.Commercial
			%		42.2nd Site
			%		43.Post Rd
			%		44.Lot Improvemen
			%		45.Subdivision Lo
			%		46.Golf Course
Total Acreage			126.20		

Bowdoin

Map Lot 09-32-0

Account 971

Location WEST RD

Card 1 Of 1 7/19/2022

Building Style 0 Not Coded	SF Bsmt Living 0	Layout 0
0.Not Code 4.Cape 8.Log	Fin Bsmt Grade 0 0	1.Typical 4. 7.
1.Conv. 5.Garrison 9.Other	OCCUPANCY 0	2.Inadeq 5. 8.
2.Ranch 6.Split 10.DW	Heat Type 100% 0 Not Coded	3.Poor 6. 9.
3.R Ranch 7.Contemp 11.Church	0.Not Code 4.Steam 8.FI/Wall	Attic 0
Dwelling Units 0	1.HWBB 5.FWA 9.No Heat	1.1/4 Fin 4.Full Fin 7.
Other Units 0	2.HWCI 6.GravWA 11.	2.1/2 Fin 5.FI/Stair 8.
Stories 0	3.H Pump 7.Electric 12.	3.3/4 Fin 6. 9.None
1.1 4.1.5 7.4	Cool Type 0% 9 None	Insulation 0
2.2 5.1.75 8.20	1.Refrig 4.W&C Air 7.	1.Full 4.Minimal 7.
3.3 6.2.5 9.Yurt	2.Evapor 5. 8.	2.Heavy 5. 8.
Exterior Walls 0 Not Coded	3.H Pump 6. 9.None	3.Capped 6. 9.None
0.Not Code 4.Asbestos 8.Concrete	Kitchen Style 0	Unfinished % 0%
1.Wood 5.Stucco 9.Other	1.Modern 4.Obsolete 7.	Grade & Factor 0 0%
2.Vin/Al 6.Brick 10.Board B	2.Typical 5. 8.	1.E Grade 4.B Grade 7.
3.Compos. 7.Stone 12.	3.Old Type 6. 9.None	2.D Grade 5.A Grade 8.
Roof Surface 0	Bath(s) Style 0	3.C Grade 6.AA Grade 9.Same
1.Asphalt 4.Composit 7.	1.Modern 4.Obsolete 7.	SQFT (Footprint) 0
2.Slate 5.Wood 8.	2.Typical 5. 8.	Condition 0
3.Metal 6.Other 9.	3.Old Type 6. 9.None	1.Poor 4.Avg 7.V G
SF Masonry Trim 0	# Rooms 0	2.Fair 5.Avg+ 8.Exc
SEPTIC DESIGN 0	# Bedrooms 0	3.Avg- 6.Good 9.Same
BLDG PERMIT 0	# Full Baths 0	Phys. % Good 0%
Year Built 0	# Half Baths 0	Funct. % Good 100%
Year Remodeled 0	# Addn Fixtures 0	Functional Code 9 None
Foundation 0	# Fireplaces 0	1.Incomp 4.Delap 7.No Power
1.Concrete 4.Wood 7.		2.O-Built 5.Bsmt 8.LongTerm
2.C Block 5.Slab 8.		3.Damage 6.Dbwd 9.None
3.Br/Stone 6.Piers 9.		Econ. % Good 100%
Basement 0		Economic Code None
1.1/4 Bmt 4.Full Bmt 7.		0.None 3.No Power 7.
2.1/2 Bmt 5.None 8.		1.Location 4.Generate 8.
3.3/4 Bmt 6. 9.None		2.Encroach 9.None 9.
Bsmt Gar # Cars 0		Entrance Code 0
Wet Basement 0		1.Interior 4.Vacant 7.Entered
1.Dry 4. 7.		2.Refusal 5.Estimate 8.No
2.Damp 5. 8.	3.Informed 6.Reviewed 9.Land	
3.Wet 6. 9.	Information Code 0	
	1.Owner 4.Agent 7.	
	2.Relative 5.Estimate 8.	
	3.Tenant 6.Other 9.	

Date Inspected

Additions, Outbuildings & Improvements

Type	Year	Units	Grade	Cond	Phys.	Funct.	Sound Value
					%	%	1.One Story Fram
					%	%	2.Two Story Fram
					%	%	3.Three Story Fr
					%	%	4.1 & 1/2 Story
					%	%	5.1 & 3/4 Story
					%	%	6.2 & 1/2 Story
					%	%	21.Open Frame Por
					%	%	22.Encl Frame Por
					%	%	23.Attached Garag
					%	%	24.Frame Shed
					%	%	25.Frame Bay Wind
					%	%	26.1SFr Overhang
					%	%	27.Unfin Basement
					%	%	28.Unfinished Att
					%	%	29.Finished Attic

WEBBER, MIRIAM
12 McPHERSON LN
HARPSWELL ME 04079

B1355P307

Inspection Witnessed By:

No./Date	Description	Date Insp.
X		

Notes:

Bowdoin

Property Data			Assessment Record				
Neighborhood 9 Map 9			Year	Land	Buildings	Exempt	Total
Tree Growth Year 0			2009	11,440	0	0	11,440
Farmland Yr 0			2010	11,440	0	0	11,440
Open Space Yr 0			2011	11,440	0	0	11,440
Zone/Land Use 11 Residential 1			2012	11,440	0	0	11,440
Secondary Zone			2013	11,440	0	0	11,440
Topography			2014	11,440	0	0	11,440
1.Level 4.Below St 7.LevelBog			2015	11,440	0	0	11,440
2.Rolling 5.Low 8.Conform			2016	11,440	0	0	11,440
3.Above St 6.FZone 9.Non-Confor			2017	11,440	0	0	11,440
Utilities			2018	11,440	0	0	11,440
1.Public 4.Dr Well 7.Cesspool			2019	11,440	0	0	11,440
2.Water 5.Dug Well 8.			2020	11,440	0	0	11,440
3.Sewer 6.Septic 9.None			2021	11,440	0	0	11,440
Street			2022	11,440	0	0	11,440
1.Paved 4.Proposed 7.MHG			Land Data				
2.Semi Imp 5.R/O/W 8.DIS							
3.Gravel 6.MHP 9.None			Front Foot				
TG PLAN YEAR 0							
Tif District # 0			Type				
Sale Data							
Sale Date			Effective				
Price							
Sale Type			Influence				
1.Land 4.Mobile 7.C/I L&B							
2.L & B 5.Other 8.			Influence Codes				
3.Building 6.C/I Land 9.							
Financing			Square Foot				
1.Convent 4.Seller 7.							
2.FHA/VA 5.Private 8.			Square Feet				
3.Assumed 6.Cash 9.Unknown							
Validity			Fract. Acre				
1.Valid 4.Split 7.Renovate							
2.Related 5.Partial 8.Other			Acres				
3.Distress 6.Exempt 9.Short							
Verified			Acres				
1.Buyer 4.Agent 7.Family							
2.Seller 5.Pub Rec 8.Other			Total Acreage 2.03				
3.Lender 6.MLS 9.							

- 1.Unimproved
- 2.Excess Frtg
- 3.Topography
- 4.Size/Shape
- 5.Access
- 6.Restriction
- 7.Open Space
- 8.View/Environ
- 9.Fract Share
- Acres**
- 30.Rear Land 3
- 31.Tillable
- 32.Pasture
- 33.Orchard
- 34.Softwood F&O
- 35.Mixed Wood F&O
- 36.Hardwood F&O
- 37.Softwood TG
- 38.Mixed Wood TG
- 39.Hardwood TG
- 40.Wasteland
- 41.Commercial
- 42.2nd Site
- 43.Post Rd
- 44.Lot Improvemen
- 45.Subdivision Lo
- 46.Golf Course

Bowdoin

Map Lot 09-32-01

Account 972

Location WEST RD

Card 1 Of 1 7/19/2022

Building Style 0 Not Coded	SF Bsmt Living 0	Layout 0
0.Not Code 4.Cape 8.Log	Fin Bsmt Grade 0 0	1.Typical 4. 7.
1.Conv. 5.Garrison 9.Other	OCCUPANCY 0	2.Inadeq 5. 8.
2.Ranch 6.Split 10.DW	Heat Type 100% 0 Not Coded	3.Poor 6. 9.
3.R Ranch 7.Contemp 11.Church	0.Not Code 4.Steam 8.FI/Wall	Attic 0
Dwelling Units 0	1.HWBB 5.FWA 9.No Heat	1.1/4 Fin 4.Full Fin 7.
Other Units 0	2.HWCI 6.GravWA 11.	2.1/2 Fin 5.FI/Stair 8.
Stories 0	3.H Pump 7.Electric 12.	3.3/4 Fin 6. 9.None
1.1 4.1.5 7.4	Cool Type 0% 9 None	Insulation 0
2.2 5.1.75 8.20	1.Refrig 4.W&C Air 7.	1.Full 4.Minimal 7.
3.3 6.2.5 9.Yurt	2.Evapor 5. 8.	2.Heavy 5. 8.
Exterior Walls 0 Not Coded	3.H Pump 6. 9.None	3.Capped 6. 9.None
0.Not Code 4.Asbestos 8.Concrete	Kitchen Style 0	Unfinished % 0%
1.Wood 5.Stucco 9.Other	1.Modern 4.Obsolete 7.	Grade & Factor 0 0%
2.Vin/Al 6.Brick 10.Board B	2.Typical 5. 8.	1.E Grade 4.B Grade 7.
3.Compos. 7.Stone 12.	3.Old Type 6. 9.None	2.D Grade 5.A Grade 8.
Roof Surface 0	Bath(s) Style 0	3.C Grade 6.AA Grade 9.Same
1.Asphalt 4.Composit 7.	1.Modern 4.Obsolete 7.	SQFT (Footprint) 0
2.Slate 5.Wood 8.	2.Typical 5. 8.	Condition 0
3.Metal 6.Other 9.	3.Old Type 6. 9.None	1.Poor 4.Avg 7.V G
SF Masonry Trim 0	# Rooms 0	2.Fair 5.Avg+ 8.Exc
SEPTIC DESIGN 0	# Bedrooms 0	3.Avg- 6.Good 9.Same
BLDG PERMIT 0	# Full Baths 0	Phys. % Good 0%
Year Built 0	# Half Baths 0	Funct. % Good 100%
Year Remodeled 0	# Addn Fixtures 0	Functional Code 9 None
Foundation 0	# Fireplaces 0	1.Incomp 4.Delap 7.No Power
1.Concrete 4.Wood 7.		2.O-Built 5.Bsmt 8.LongTerm
2.C Block 5.Slab 8.		3.Damage 6.Dbwd 9.None
3.Br/Stone 6.Piers 9.		Econ. % Good 100%
Basement 0		Economic Code None
1.1/4 Bmt 4.Full Bmt 7.		0.None 3.No Power 7.
2.1/2 Bmt 5.None 8.		1.Location 4.Generate 8.
3.3/4 Bmt 6. 9.None		2.Encroach 9.None 9.
Bsmt Gar # Cars 0		Entrance Code 0
Wet Basement 0		1.Interior 4.Vacant 7.Entered
1.Dry 4. 7.		2.Refusal 5.Estimate 8.No
2.Damp 5. 8.		3.Informed 6.Reviewed 9.Land
3.Wet 6. 9.		Information Code 0
		1.Owner 4.Agent 7.
		2.Relative 5.Estimate 8.
		3.Tenant 6.Other 9.



Date Inspected

Additions, Outbuildings & Improvements								
Type	Year	Units	Grade	Cond	Phys.	Funct.	Sound Value	
					%	%		1.One Story Fram
					%	%		2.Two Story Fram
					%	%		3.Three Story Fr
					%	%		4.1 & 1/2 Story
					%	%		5.1 & 3/4 Story
					%	%		6.2 & 1/2 Story
					%	%		21.Open Frame Por
					%	%		22.Encl Frame Por
					%	%		23.Attached Garag
					%	%		24.Frame Shed
					%	%		25.Frame Bay Wind
					%	%		26.1SFr Overhang
					%	%		27.Unfin Basement
					%	%		28.Unfinished Att
					%	%		29.Finished Attic

FENIMORE, DONALD T
92 KEAY RD
BOWDOIN ME 04287

B359P1038

Inspection Witnessed By:

X

Date

No./Date	Description	Date Insp.

Notes:

Bowdoin

Property Data			Assessment Record						
Neighborhood 9 Map 9			Year	Land	Buildings	Exempt	Total		
Tree Growth Year 0			2009	48,200	73,910	10,000	112,110		
Farmland Yr 0			2010	48,200	73,910	10,000	112,110		
Open Space Yr 0			2011	48,200	73,910	10,000	112,110		
Zone/Land Use 11 Residential 1			2012	48,200	73,910	10,000	112,110		
Secondary Zone			2013	48,200	73,910	10,000	112,110		
Topography			2014	48,200	73,910	10,000	112,110		
1.Level 4.Below St 7.LevelBog			2015	48,200	73,910	10,000	112,110		
2.Rolling 5.Low 8.Conform			2016	48,200	73,910	15,000	107,110		
3.Above St 6.FZone 9.Non-Confor			2017	48,200	73,910	20,000	102,110		
Utilities			2018	48,200	73,910	20,000	102,110		
1.Public 4.Dr Well 7.Cesspool			2019	48,200	73,910	20,000	102,110		
2.Water 5.Dug Well 8.			2020	48,200	73,910	25,000	97,110		
3.Sewer 6.Septic 9.None			2021	48,200	73,910	25,000	97,110		
Street 1 Paved			2022	48,200	73,910	21,500	100,610		
1.Paved 4.Proposed 7.MHG			Land Data						
2.Semi Imp 5.R/O/W 8.DIS									
3.Gravel 6.MHP 9.None			Front Foot	Type	Effective		Influence		Influence Codes 1.Unimproved 2.Excess Frtg 3.Topography 4.Size/Shape 5.Access 6.Restriction 7.Open Space 8.View/Environ 9.Fract Share Acres 30.Rear Land 3 31.Tillable 32.Pasture 33.Orchard 34.Softwood F&O 35.Mixed Wood F&O 36.Hardwood F&O 37.Softwood TG 38.Mixed Wood TG 39.Hardwood TG 40.Wasteland 41.Commercial 42.2nd Site 43.Post Rd 44.Lot Improvemen 45.Subdivision Lo 46.Golf Course
TG PLAN YEAR 0			11.Road Frontage		Frontage	Depth	Factor	Code	
Tif District # 0			12.Delta Triangle				%		
Sale Data			13.Nabla Triangle				%		
Sale Date			14.Rear Land				%		
Price			15.Miscellaneous				%		
Sale Type							%		
1.Land 4.Mobile 7.C/I L&B			Square Foot	Square Feet					
2.L & B 5.Other 8.			16.Regular Lot				%		
3.Building 6.C/I Land 9.			17.Secondary Lot				%		
Financing			18.Hydro Facility				%		
1.Convent 4.Seller 7.			19.Improvements				%		
2.FHA/VA 5.Private 8.			20.Base 3 (Fract)				%		
3.Assumed 6.Cash 9.Unknown							%		
Validity			Fract. Acre		Acres/Sites				
1.Valid 4.Split 7.Renovate			21.Base 1 (Fract)	24	1.00	100	%	0	
2.Related 5.Partial 8.Other			22.Base 2 (Fract)	28	0.50	100	%	0	
3.Distress 6.Exempt 9.Short			23.Base 3	44	1.00	100	%	0	
Verified			Acres				%		
1.Buyer 4.Agent 7.Family			24.Base 1				%		
2.Seller 5.Pub Rec 8.Other			25.Base 2				%		
3.Lender 6.MLS 9.			26.Frontage 1				%		
			27.Rear Land 4				%		
			28.Rear Land 1				%		
			29.Rear Land 2				%		
			Total Acreage		1.50				

Bowdoin

Map Lot 09-33-0

Account 973

Location 92 KEAY RD

Card 1 Of 1 7/19/2022

Building Style 5 Garrison	SF Bsmt Living 0	Layout 1 Typical
0.Not Code 4.Cape 8.Log	Fin Bsmt Grade 0 0	1.Typical 4. 7.
1.Conv. 5.Garrison 9.Other	OCCUPANCY 0	2.Inadeq 5. 8.
2.Ranch 6.Split 10.DW	Heat Type 100% 5 Forced Warm Air	3.Poor 6. 9.
3.R Ranch 7.Contemp 11.Church	0.Not Code 4.Steam 8.FI/Wall	Attic 9 None
Dwelling Units 1	1.HWBB 5.FWA 9.No Heat	1.1/4 Fin 4.Full Fin 7.
Other Units 0	2.HWCI 6.GravWA 11.	2.1/2 Fin 5.FI/Stair 8.
Stories 2 Two Story	3.H Pump 7.Electric 12.	3.3/4 Fin 6. 9.None
1.1 4.1.5 7.4	Cool Type 0% 9 None	Insulation 3 Capped Only
2.2 5.1.75 8.20	1.Refrig 4.W&C Air 7.	1.Full 4.Minimal 7.
3.3 6.2.5 9.Yurt	2.Evapor 5. 8.	2.Heavy 5. 8.
Exterior Walls 2 Vinyl/Aluminum	3.H Pump 6. 9.None	3.Capped 6. 9.None
0.Not Code 4.Asbestos 8.Concrete	Kitchen Style 2 Typical	Unfinished % 0%
1.Wood 5.Stucco 9.Other	1.Modern 4.Obsolete 7.	Grade & Factor 3 Average 100%
2.Vin/Al 6.Brick 10.Board B	2.Typical 5. 8.	1.E Grade 4.B Grade 7.
3.Compos. 7.Stone 12.	3.Old Type 6. 9.None	2.D Grade 5.A Grade 8.
Roof Surface 1 Asphalt Shingles	Bath(s) Style 2 Typical Bath(s)	3.C Grade 6.AA Grade 9.Same
1.Asphalt 4.Composit 7.	1.Modern 4.Obsolete 7.	SQFT (Footprint) 762
2.Slate 5.Wood 8.	2.Typical 5. 8.	Condition 3 Below Average
3.Metal 6.Other 9.	3.Old Type 6. 9.None	1.Poor 4.Avg 7.V G
SF Masonry Trim 0	# Rooms 11	2.Fair 5.Avg+ 8.Exc
SEPTIC DESIGN 0	# Bedrooms 4	3.Avg- 6.Good 9.Same
BLDG PERMIT 0	# Full Baths 1	Phys. % Good 0%
Year Built 1900	# Half Baths 0	Funct. % Good 100%
Year Remodeled 0	# Addn Fixtures 0	Functional Code 9 None
Foundation 3 Brick &/or Stone	# Fireplaces 0	1.Incomp 4.Delap 7.No Power
1.Concrete 4.Wood 7.		2.O-Built 5.Bsmt 8.LongTerm
2.C Block 5.Slab 8.		3.Damage 6.Dbwd 9.None
3.Br/Stone 6.Piers 9.		Econ. % Good 100%
Basement 4 Full Basement		Economic Code None
1.1/4 Bmt 4.Full Bmt 7.		0.None 3.No Power 7.
2.1/2 Bmt 5.None 8.		1.Location 4.Generate 8.
3.3/4 Bmt 6. 9.None		2.Encroach 9.None 9.
Bsmt Gar # Cars 0		Entrance Code 0
Wet Basement 3 Wet Basement		1.Interior 4.Vacant 7.Entered
1.Dry 4. 7.		2.Refusal 5.Estimate 8.No
2.Damp 5. 8.	3.Informed 6.Reviewed 9.Land	
3.Wet 6. 9.	Information Code 0	
	1.Owner 4.Agent 7.	
	2.Relative 5.Estimate 8.	
	3.Tenant 6.Other 9.	

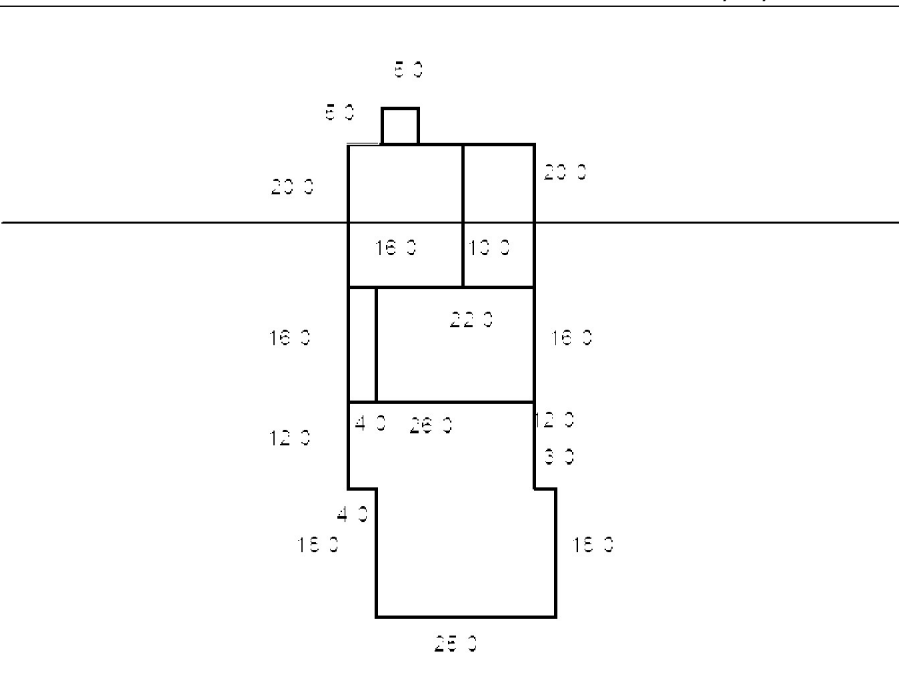

Date Inspected

Additions, Outbuildings & Improvements

Type	Year	Units	Grade	Cond	Phys.	Funct.	Sound Value
11 One	0	352	3 100	3	0 %	95 %	
11 One	0	320	3 100	3	0 %	95 %	
21 Open Frame	0	64	3 100	3	0 %	95 %	
40 Basement Entry	0	25	2 110	3	0 %	100 %	
					%	%	
					%	%	
					%	%	
					%	%	
					%	%	
					%	%	
					%	%	
					%	%	

- 1.One Story Fram
- 2.Two Story Fram
- 3.Three Story Fr
- 4.1 & 1/2 Story
- 5.1 & 3/4 Story
- 6.2 & 1/2 Story
- 21.Open Frame Por
- 22.Encl Frame Por
- 23.Attached Garag
- 24.Frame Shed
- 25.Frame Bay Wind
- 26.1SFr Overhang
- 27.Unfin Basement
- 28.Unfinished Att
- 29.Finished Attic

Bowdoin

Map Lot 09-34-0

Account 974

Location KEAY RD

Card 1 Of 1 7/19/2022

Building Style 0 Not Coded	SF Bsmt Living 0	Layout 0
0.Not Code 4.Cape 8.Log	Fin Bsmt Grade 0 0	1.Typical 4. 7.
1.Conv. 5.Garrison 9.Other	OCCUPANCY 0	2.Inadeq 5. 8.
2.Ranch 6.Split 10.DW	Heat Type 100% 0 Not Coded	3.Poor 6. 9.
3.R Ranch 7.Contemp 11.Church	0.Not Code 4.Steam 8.FI/Wall	Attic 0
Dwelling Units 0	1.HWBB 5.FWA 9.No Heat	1.1/4 Fin 4.Full Fin 7.
Other Units 0	2.HWCI 6.GravWA 11.	2.1/2 Fin 5.FI/Stair 8.
Stories 0	3.H Pump 7.Electric 12.	3.3/4 Fin 6. 9.None
1.1 4.1.5 7.4	Cool Type 0% 9 None	Insulation 0
2.2 5.1.75 8.20	1.Refrig 4.W&C Air 7.	1.Full 4.Minimal 7.
3.3 6.2.5 9.Yurt	2.Evapor 5. 8.	2.Heavy 5. 8.
Exterior Walls 0 Not Coded	3.H Pump 6. 9.None	3.Capped 6. 9.None
0.Not Code 4.Asbestos 8.Concrete	Kitchen Style 0	Unfinished % 0%
1.Wood 5.Stucco 9.Other	1.Modern 4.Obsolete 7.	Grade & Factor 0 0%
2.Vin/Al 6.Brick 10.Board B	2.Typical 5. 8.	1.E Grade 4.B Grade 7.
3.Compos. 7.Stone 12.	3.Old Type 6. 9.None	2.D Grade 5.A Grade 8.
Roof Surface 0	Bath(s) Style 0	3.C Grade 6.AA Grade 9.Same
1.Asphalt 4.Composit 7.	1.Modern 4.Obsolete 7.	SQFT (Footprint) 0
2.Slate 5.Wood 8.	2.Typical 5. 8.	Condition 0
3.Metal 6.Other 9.	3.Old Type 6. 9.None	1.Poor 4.Avg 7.V G
SF Masonry Trim 0	# Rooms 0	2.Fair 5.Avg+ 8.Exc
SEPTIC DESIGN 0	# Bedrooms 0	3.Avg- 6.Good 9.Same
BLDG PERMIT 0	# Full Baths 0	Phys. % Good 0%
Year Built 0	# Half Baths 0	Funct. % Good 100%
Year Remodeled 0	# Addn Fixtures 0	Functional Code 9 None
Foundation 0	# Fireplaces 0	1.Incomp 4.Delap 7.No Power
1.Concrete 4.Wood 7.		2.O-Built 5.Bsmt 8.LongTerm
2.C Block 5.Slab 8.		3.Damage 6.Dbwd 9.None
3.Br/Stone 6.Piers 9.		Econ. % Good 100%
Basement 0		Economic Code None
1.1/4 Bmt 4.Full Bmt 7.		0.None 3.No Power 7.
2.1/2 Bmt 5.None 8.		1.Location 4.Generate 8.
3.3/4 Bmt 6. 9.None		2.Encroach 9.None 9.
Bsmt Gar # Cars 0		Entrance Code 0
Wet Basement 0		1.Interior 4.Vacant 7.Entered
1.Dry 4. 7.		2.Refusal 5.Estimate 8.No
2.Damp 5. 8.		3.Informed 6.Reviewed 9.Land
3.Wet 6. 9.		Information Code 0
		1.Owner 4.Agent 7.
		2.Relative 5.Estimate 8.
		3.Tenant 6.Other 9.



Date Inspected

Additions, Outbuildings & Improvements							
Type	Year	Units	Grade	Cond	Phys.	Funct.	Sound Value
					%	%	1.One Story Fram
					%	%	2.Two Story Fram
					%	%	3.Three Story Fr
					%	%	4.1 & 1/2 Story
					%	%	5.1 & 3/4 Story
					%	%	6.2 & 1/2 Story
					%	%	21.Open Frame Por
					%	%	22.Encl Frame Por
					%	%	23.Attached Garag
					%	%	24.Frame Shed
					%	%	25.Frame Bay Wind
					%	%	26.1SFr Overhang
					%	%	27.Unfin Basement
					%	%	28.Unfinished Att
					%	%	29.Finished Attic

GANNON, NICHOLAS
CAMIRE, LINDSAY
118 KEAY RD
SABATTUS ME 04280

B1510P85 B2855P43 B3200P88

Previous Owner
ELLSWORTH, LIVING TRUST FOR RAYMOND W.
ELLSWORTH, LIVING TRUST FOR VALENTINE M
154 KEAY RD
SABATTUS ME 04280
Sale Date: 6/18/2010

Inspection Witnessed By:

X	Date	Date Insp.
No./Date	Description	Date Insp.

Notes:

Bowdoin

Property Data			Assessment Record				
Neighborhood 9 Map 9			Year	Land	Buildings	Exempt	Total
Tree Growth Year 0			2009	500	0	0	500
Farmland Yr 0			2010	500	0	0	500
Open Space Yr 0			2011	500	0	0	500
Zone/Land Use 11 Residential 1			2012	500	0	0	500
Secondary Zone			2013	320	0	0	320
Topography			2014	320	0	0	320
1.Level 4.Below St 7.LevelBog			2015	320	0	0	320
2.Rolling 5.Low 8.Conform			2016	320	0	0	320
3.Above St 6.FZone 9.Non-Confor			2017	320	0	0	320
Utilities			2018	320	0	0	320
1.Public 4.Dr Well 7.Cesspool			2019	320	0	0	320
2.Water 5.Dug Well 8.			2020	320	0	0	320
3.Sewer 6.Septic 9.None			2021	320	0	0	320
Street 1 Paved			2022	320	0	0	320
1.Paved 4.Proposed 7.MHG			Land Data				
2.Semi Imp 5.R/O/W 8.DIS							
3.Gravel 6.MHP 9.None			Front Foot				
TG PLAN YEAR 0							
Tif District # 0			Type				
Sale Data							
Sale Date 6/18/2010			Effective				
Price							
Sale Type 1 Land Only			Influence				
1.Land 4.Mobile 7.C/I L&B							
2.L & B 5.Other 8.			Influence Codes				
3.Building 6.C/I Land 9.							
Financing 9 Unknown			Acres				
1.Convent 4.Seller 7.							
2.FHA/VA 5.Private 8.			Fract. Acre				
3.Assumed 6.Cash 9.Unknown							
Validity 1 Arms Length Sale			Acres				
1.Valid 4.Split 7.Renovate							
2.Related 5.Partial 8.Other			Acres				
3.Distress 6.Exempt 9.Short							
Verified 5 Public Record			Acres				
1.Buyer 4.Agent 7.Family							
2.Seller 5.Pub Rec 8.Other			Acres				
3.Lender 6.MLS 9.							

Front Foot	Type	Effective		Influence		Influence Codes
		Frontage	Depth	Factor	Code	
11.Road Frontage				%		1.Unimproved
12.Delta Triangle				%		2.Excess Frtg
13.Nabla Triangle				%		3.Topography
14.Rear Land				%		4.Size/Shape
15.Miscellaneous				%		5.Access
				%		6.Restriction
				%		7.Open Space
				%		8.View/Environ
				%		9.Fract Share
				%		30.Rear Land 3
				%		31.Tillable
				%		32.Pasture
				%		33.Orchard
				%		34.Softwood F&O
				%		35.Mixed Wood F&O
				%		36.Hardwood F&O
				%		37.Softwood TG
				%		38.Mixed Wood TG
				%		39.Hardwood TG
				%		40.Wasteland
				%		41.Commercial
				%		42.2nd Site
				%		43.Post Rd
				%		44.Lot Improvemen
				%		45.Subdivision Lo
				%		46.Golf Course
Total Acreage		0.23				

Bowdoin

Map Lot 09-35-0

Account 975

Location KEAY RD

Card 1 Of 1 7/19/2022

Building Style 0 Not Coded	SF Bsmt Living 0	Layout 0
0.Not Code 4.Cape 8.Log	Fin Bsmt Grade 0 0	1.Typical 4. 7.
1.Conv. 5.Garrison 9.Other	OCCUPANCY 0	2.Inadeq 5. 8.
2.Ranch 6.Split 10.DW	Heat Type 100% 0 Not Coded	3.Poor 6. 9.
3.R Ranch 7.Contemp 11.Church	0.Not Code 4.Steam 8.Fi/Wall	Attic 0
Dwelling Units 0	1.HWBB 5.FWA 9.No Heat	1.1/4 Fin 4.Full Fin 7.
Other Units 0	2.HWCI 6.GravWA 11.	2.1/2 Fin 5.Fi/Stair 8.
Stories 0	3.H Pump 7.Electric 12.	3.3/4 Fin 6. 9.None
1.1 4.1.5 7.4	Cool Type 0% 9 None	Insulation 0
2.2 5.1.75 8.20	1.Refrig 4.W&C Air 7.	1.Full 4.Minimal 7.
3.3 6.2.5 9.Yurt	2.Evapor 5. 8.	2.Heavy 5. 8.
Exterior Walls 0 Not Coded	3.H Pump 6. 9.None	3.Capped 6. 9.None
0.Not Code 4.Asbestos 8.Concrete	Kitchen Style 0	Unfinished % 0%
1.Wood 5.Stucco 9.Other	1.Modern 4.Obsolete 7.	Grade & Factor 0 0%
2.Vin/Al 6.Brick 10.Board B	2.Typical 5. 8.	1.E Grade 4.B Grade 7.
3.Compos. 7.Stone 12.	3.Old Type 6. 9.None	2.D Grade 5.A Grade 8.
Roof Surface 0	Bath(s) Style 0	3.C Grade 6.AA Grade 9.Same
1.Asphalt 4.Composit 7.	1.Modern 4.Obsolete 7.	SQFT (Footprint) 0
2.Slate 5.Wood 8.	2.Typical 5. 8.	Condition 0
3.Metal 6.Other 9.	3.Old Type 6. 9.None	1.Poor 4.Avg 7.V G
SF Masonry Trim 0	# Rooms 0	2.Fair 5.Avg+ 8.Exc
SEPTIC DESIGN 0	# Bedrooms 0	3.Avg- 6.Good 9.Same
BLDG PERMIT 0	# Full Baths 0	Phys. % Good 0%
Year Built 0	# Half Baths 0	Funct. % Good 100%
Year Remodeled 0	# Addn Fixtures 0	Functional Code 9 None
Foundation 0	# Fireplaces 0	1.Incomp 4.Delap 7.No Power
1.Concrete 4.Wood 7.		2.O-Built 5.Bsmt 8.LongTerm
2.C Block 5.Slab 8.		3.Damage 6.Dbwd 9.None
3.Br/Stone 6.Piers 9.		Econ. % Good 100%
Basement 0		Economic Code None
1.1/4 Bmt 4.Full Bmt 7.		0.None 3.No Power 7.
2.1/2 Bmt 5.None 8.		1.Location 4.Generate 8.
3.3/4 Bmt 6. 9.None		2.Encroach 9.None 9.
Bsmt Gar # Cars 0		Entrance Code 0
Wet Basement 0		1.Interior 4.Vacant 7.Entered
1.Dry 4. 7.		2.Refusal 5.Estimate 8.No
2.Damp 5. 8.		3.Informed 6.Reviewed 9.Land
3.Wet 6. 9.		Information Code 0
		1.Owner 4.Agent 7.
		2.Relative 5.Estimate 8.
		3.Tenant 6.Other 9.



Date Inspected

Additions, Outbuildings & Improvements							
Type	Year	Units	Grade	Cond	Phys.	Funct.	Sound Value
					%	%	1.One Story Fram
					%	%	2.Two Story Fram
					%	%	3.Three Story Fr
					%	%	4.1 & 1/2 Story
					%	%	5.1 & 3/4 Story
					%	%	6.2 & 1/2 Story
					%	%	21.Open Frame Por
					%	%	22.Encl Frame Por
					%	%	23.Attached Garag
					%	%	24.Frame Shed
					%	%	25.Frame Bay Wind
					%	%	26.1SFr Overhang
					%	%	27.Unfin Basement
					%	%	28.Unfinished Att
					%	%	29.Finished Attic

DALEY, EDWARD J
 DALEY, JEANNINE T
 835 MAIN ST
 BOWDOIN ME 04287

B1070P210

Inspection Witnessed By:

X		Date
No./Date	Description	Date Insp.

Notes:

Bowdoin

Property Data			Assessment Record				
Neighborhood 9 Map 9			Year	Land	Buildings	Exempt	Total
Tree Growth Year 0			2009	3,000	0	0	3,000
Farmland Yr 0			2010	3,000	0	0	3,000
Open Space Yr 0			2011	3,000	0	0	3,000
Zone/Land Use 11 Residential 1			2012	3,000	0	0	3,000
Secondary Zone			2013	3,000	0	0	3,000
Topography			2014	3,000	0	0	3,000
1.Level 4.Below St 7.LevelBog			2015	3,000	0	0	3,000
2.Rolling 5.Low 8.Conform			2016	3,000	0	0	3,000
3.Above St 6.FZone 9.Non-Confor			2017	3,000	0	0	3,000
Utilities			2018	3,000	0	0	3,000
1.Public 4.Dr Well 7.Cesspool			2019	3,000	0	0	3,000
2.Water 5.Dug Well 8.			2020	3,000	0	0	3,000
3.Sewer 6.Septic 9.None			2021	3,000	0	0	3,000
Street			2022	3,000	0	0	3,000
1.Paved 4.Proposed 7.MHG			Land Data				
2.Semi Imp 5.R/O/W 8.DIS							
3.Gravel 6.MHP 9.None			Front Foot				
TG PLAN YEAR 0							
Tif District # 0			Type				
Sale Data							
Sale Date			Effective				
Price							
Sale Type			Influence				
1.Land 4.Mobile 7.C/I L&B							
2.L & B 5.Other 8.			Influence Codes				
3.Building 6.C/I Land 9.							
Financing			Square Foot				
1.Convent 4.Seller 7.							
2.FHA/VA 5.Private 8.			Square Feet				
3.Assumed 6.Cash 9.Unknown							
Validity			Fract. Acre				
1.Valid 4.Split 7.Renovate							
2.Related 5.Partial 8.Other			Acres				
3.Distress 6.Exempt 9.Short							
Verified			Acres				
1.Buyer 4.Agent 7.Family							
2.Seller 5.Pub Rec 8.Other			Acres				
3.Lender 6.MLS 9.							

Type	Effective		Influence		Influence Codes
	Frontage	Depth	Factor	Code	
11.Road Frontage			%		1.Unimproved
12.Delta Triangle			%		2.Excess Frtg
13.Nabla Triangle			%		3.Topography
14.Rear Land			%		4.Size/Shape
15.Miscellaneous			%		5.Access
			%		6.Restriction
			%		7.Open Space
			%		8.View/Environ
			%		9.Fract Share
			%		Acres
			%		30.Rear Land 3
			%		31.Tillable
			%		32.Pasture
			%		33.Orchard
			%		34.Softwood F&O
			%		35.Mixed Wood F&O
23	0.30	100	%	0	36.Hardwood F&O
			%		37.Softwood TG
			%		38.Mixed Wood TG
			%		39.Hardwood TG
			%		40.Wasteland
			%		41.Commercial
			%		42.2nd Site
			%		43.Post Rd
Total Acreage 0.30					44.Lot Improvemen
					45.Subdivision Lo
					46.Golf Course

Bowdoin

Map Lot 09-35-01

Account 976

Location 112 KEAY RD

Card 1 Of 1 7/19/2022

Building Style 0 Not Coded	SF Bsmt Living 0	Layout 0
0.Not Code 4.Cape 8.Log	Fin Bsmt Grade 0 0	1.Typical 4. 7.
1.Conv. 5.Garrison 9.Other	OCCUPANCY 0	2.Inadeq 5. 8.
2.Ranch 6.Split 10.DW	Heat Type 100% 0 Not Coded	3.Poor 6. 9.
3.R Ranch 7.Contemp 11.Church	0.Not Code 4.Steam 8.FI/Wall	Attic 0
Dwelling Units 0	1.HWBB 5.FWA 9.No Heat	1.1/4 Fin 4.Full Fin 7.
Other Units 0	2.HWCI 6.GravWA 11.	2.1/2 Fin 5.FI/Stair 8.
Stories 0	3.H Pump 7.Electric 12.	3.3/4 Fin 6. 9.None
1.1 4.1.5 7.4	Cool Type 0% 9 None	Insulation 0
2.2 5.1.75 8.20	1.Refrig 4.W&C Air 7.	1.Full 4.Minimal 7.
3.3 6.2.5 9.Yurt	2.Evapor 5. 8.	2.Heavy 5. 8.
Exterior Walls 0 Not Coded	3.H Pump 6. 9.None	3.Capped 6. 9.None
0.Not Code 4.Asbestos 8.Concrete	Kitchen Style 0	Unfinished % 0%
1.Wood 5.Stucco 9.Other	1.Modern 4.Obsolete 7.	Grade & Factor 0 0%
2.Vin/Al 6.Brick 10.Board B	2.Typical 5. 8.	1.E Grade 4.B Grade 7.
3.Compos. 7.Stone 12.	3.Old Type 6. 9.None	2.D Grade 5.A Grade 8.
Roof Surface 0	Bath(s) Style 0	3.C Grade 6.AA Grade 9.Same
1.Asphalt 4.Composit 7.	1.Modern 4.Obsolete 7.	SQFT (Footprint) 0
2.Slate 5.Wood 8.	2.Typical 5. 8.	Condition 0
3.Metal 6.Other 9.	3.Old Type 6. 9.None	1.Poor 4.Avg 7.V G
SF Masonry Trim 0	# Rooms 0	2.Fair 5.Avg+ 8.Exc
SEPTIC DESIGN 0	# Bedrooms 0	3.Avg- 6.Good 9.Same
BLDG PERMIT 0	# Full Baths 0	Phys. % Good 0%
Year Built 0	# Half Baths 0	Funct. % Good 100%
Year Remodeled 0	# Addn Fixtures 0	Functional Code 9 None
Foundation 0	# Fireplaces 0	1.Incomp 4.Delap 7.No Power
1.Concrete 4.Wood 7.		2.O-Built 5.Bsmt 8.LongTerm
2.C Block 5.Slab 8.		3.Damage 6.Dbwd 9.None
3.Br/Stone 6.Piers 9.		Econ. % Good 100%
Basement 0		Economic Code None
1.1/4 Bmt 4.Full Bmt 7.		0.None 3.No Power 7.
2.1/2 Bmt 5.None 8.		1.Location 4.Generate 8.
3.3/4 Bmt 6. 9.None		2.Encroach 9.None 9.
Bsmt Gar # Cars 0		Entrance Code 0
Wet Basement 0		1.Interior 4.Vacant 7.Entered
1.Dry 4. 7.		2.Refusal 5.Estimate 8.No
2.Damp 5. 8.	3.Informed 6.Reviewed 9.Land	
3.Wet 6. 9.	Information Code 0	
	1.Owner 4.Agent 7.	
	2.Relative 5.Estimate 8.	
	3.Tenant 6.Other 9.	

Date Inspected

Additions, Outbuildings & Improvements							
Type	Year	Units	Grade	Cond	Phys.	Funct.	Sound Value
					%	%	1.One Story Fram
					%	%	2.Two Story Fram
					%	%	3.Three Story Fr
					%	%	4.1 & 1/2 Story
					%	%	5.1 & 3/4 Story
					%	%	6.2 & 1/2 Story
					%	%	21.Open Frame Por
					%	%	22.Encl Frame Por
					%	%	23.Attached Garag
					%	%	24.Frame Shed
					%	%	25.Frame Bay Wind
					%	%	26.1SFr Overhang
					%	%	27.Unfin Basement
					%	%	28.Unfinished Att
					%	%	29.Finished Attic

NORMAN, HERBERT J
 VENO, JENNIFER L
 114 KEAY RD
 SABATTUS ME
 B1761P94 B3201P110 B3204P166

Previous Owner
 FEDERAL NATIONAL MORTGAGE ASSOC
 950 PACES FERRY RD
 ATLANTA GA 30326
 Sale Date: 7/09/2010

Previous Owner
 BENNETT, DEVISEES OF REX A
 114 KEAY RD
 SABATTUS ME 04280
 Sale Date: 4/16/2010

Inspection Witnessed By:
 X _____ Date _____

No./Date	Description	Date Insp.

Notes:

Bowdoin

Property Data			Assessment Record				
Neighborhood 9 Map 9			Year	Land	Buildings	Exempt	Total
Tree Growth Year 0			2009	24,660	0	0	24,660
Farmland Yr 0			2010	24,660	0	0	24,660
Open Space Yr 0			2011	24,660	0	0	24,660
Zone/Land Use 11 Residential 1			2012	24,660	0	0	24,660
Secondary Zone			2013	24,660	0	0	24,660
Topography			2014	24,660	0	0	24,660
1.Level 4.Below St 7.LevelBog			2015	24,660	0	0	24,660
2.Rolling 5.Low 8.Conform			2016	24,660	0	0	24,660
3.Above St 6.FZone 9.Non-Confor			2017	24,660	0	0	24,660
Utilities			2018	24,660	0	0	24,660
1.Public 4.Dr Well 7.Cesspool			2019	24,660	0	0	24,660
2.Water 5.Dug Well 8.			2020	24,660	0	0	24,660
3.Sewer 6.Septic 9.None			2021	24,660	0	0	24,660
Street			2022	24,660	0	0	24,660
1.Paved 4.Proposed 7.MHG			Land Data				
2.Semi Imp 5.R/O/W 8.DIS							
3.Gravel 6.MHP 9.None			Front Foot				
TG PLAN YEAR 0							
Tif District # 0			Type				
Sale Data							
Sale Date 7/09/2010			Effective				
Price 14,900							
Sale Type 1 Land Only			Influence				
1.Land 4.Mobile 7.C/I L&B							
2.L & B 5.Other 8.			Influence Codes				
3.Building 6.C/I Land 9.							
Financing 9 Unknown			Square Foot				
1.Convent 4.Seller 7.							
2.FHA/VA 5.Private 8.			Square Feet				
3.Assumed 6.Cash 9.Unknown							
Validity 8 Other Non Valid			Fract. Acre				
1.Valid 4.Split 7.Renovate							
2.Related 5.Partial 8.Other			Acres				
3.Distress 6.Exempt 9.Short							
Verified 5 Public Record			Acreege/Sites				
1.Buyer 4.Agent 7.Family							
2.Seller 5.Pub Rec 8.Other			Total Acreage 0.38				
3.Lender 6.MLS 9.							

- 1.Unimproved
- 2.Excess Frtg
- 3.Topography
- 4.Size/Shape
- 5.Access
- 6.Restriction
- 7.Open Space
- 8.View/Environ
- 9.Fract Share
- Acres**
- 30.Rear Land 3
- 31.Tillable
- 32.Pasture
- 33.Orchard
- 34.Softwood F&O
- 35.Mixed Wood F&O
- 36.Hardwood F&O
- 37.Softwood TG
- 38.Mixed Wood TG
- 39.Hardwood TG
- 40.Wasteland
- 41.Commercial
- 42.2nd Site
- 43.Post Rd
- 44.Lot Improvemen
- 45.Subdivision Lo
- 46.Golf Course

Bowdoin

Map Lot 09-35-02

Account 977

Location KEAY RD

Card 1 Of 1 7/19/2022

Building Style 0 Not Coded	SF Bsmt Living 0	Layout 0
0.Not Code 4.Cape 8.Log	Fin Bsmt Grade 0 0	1.Typical 4. 7.
1.Conv. 5.Garrison 9.Other	OCCUPANCY 0	2.Inadeq 5. 8.
2.Ranch 6.Split 10.DW	Heat Type 100% 0 Not Coded	3.Poor 6. 9.
3.R Ranch 7.Contemp 11.Church	0.Not Code 4.Steam 8.FI/Wall	Attic 0
Dwelling Units 0	1.HWBB 5.FWA 9.No Heat	1.1/4 Fin 4.Full Fin 7.
Other Units 0	2.HWCI 6.GravWA 11.	2.1/2 Fin 5.FI/Stair 8.
Stories 0	3.H Pump 7.Electric 12.	3.3/4 Fin 6. 9.None
1.1 4.1.5 7.4	Cool Type 0% 9 None	Insulation 0
2.2 5.1.75 8.20	1.Refrig 4.W&C Air 7.	1.Full 4.Minimal 7.
3.3 6.2.5 9.Yurt	2.Evapor 5. 8.	2.Heavy 5. 8.
Exterior Walls 0 Not Coded	3.H Pump 6. 9.None	3.Capped 6. 9.None
0.Not Code 4.Asbestos 8.Concrete	Kitchen Style 0	Unfinished % 0%
1.Wood 5.Stucco 9.Other	1.Modern 4.Obsolete 7.	Grade & Factor 0 0%
2.Vin/Al 6.Brick 10.Board B	2.Typical 5. 8.	1.E Grade 4.B Grade 7.
3.Compos. 7.Stone 12.	3.Old Type 6. 9.None	2.D Grade 5.A Grade 8.
Roof Surface 0	Bath(s) Style 0	3.C Grade 6.AA Grade 9.Same
1.Asphalt 4.Composit 7.	1.Modern 4.Obsolete 7.	SQFT (Footprint) 0
2.Slate 5.Wood 8.	2.Typical 5. 8.	Condition 0
3.Metal 6.Other 9.	3.Old Type 6. 9.None	1.Poor 4.Avg 7.V G
SF Masonry Trim 0	# Rooms 0	2.Fair 5.Avg+ 8.Exc
SEPTIC DESIGN 0	# Bedrooms 0	3.Avg- 6.Good 9.Same
BLDG PERMIT 0	# Full Baths 0	Phys. % Good 0%
Year Built 0	# Half Baths 0	Funct. % Good 100%
Year Remodeled 0	# Addn Fixtures 0	Functional Code 9 None
Foundation 0	# Fireplaces 0	1.Incomp 4.Delap 7.No Power
1.Concrete 4.Wood 7.		2.O-Built 5.Bsmt 8.LongTerm
2.C Block 5.Slab 8.		3.Damage 6.Dbwd 9.None
3.Br/Stone 6.Piers 9.		Econ. % Good 100%
Basement 0		Economic Code None
1.1/4 Bmt 4.Full Bmt 7.		0.None 3.No Power 7.
2.1/2 Bmt 5.None 8.		1.Location 4.Generate 8.
3.3/4 Bmt 6. 9.None		2.Encroach 9.None 9.
Bsmt Gar # Cars 0		Entrance Code 0
Wet Basement 0		1.Interior 4.Vacant 7.Entered
1.Dry 4. 7.		2.Refusal 5.Estimate 8.No
2.Damp 5. 8.	3.Informed 6.Reviewed 9.Land	
3.Wet 6. 9.	Information Code 0	
	1.Owner 4.Agent 7.	
	2.Relative 5.Estimate 8.	
	3.Tenant 6.Other 9.	

Date Inspected

Additions, Outbuildings & Improvements

Type	Year	Units	Grade	Cond	Phys.	Funct.	Sound Value
					%	%	1.One Story Fram
					%	%	2.Two Story Fram
					%	%	3.Three Story Fr
					%	%	4.1 & 1/2 Story
					%	%	5.1 & 3/4 Story
					%	%	6.2 & 1/2 Story
					%	%	21.Open Frame Por
					%	%	22.Encl Frame Por
					%	%	23.Attached Garag
					%	%	24.Frame Shed
					%	%	25.Frame Bay Wind
					%	%	26.1SFr Overhang
					%	%	27.Unfin Basement
					%	%	28.Unfinished Att
					%	%	29.Finished Attic